

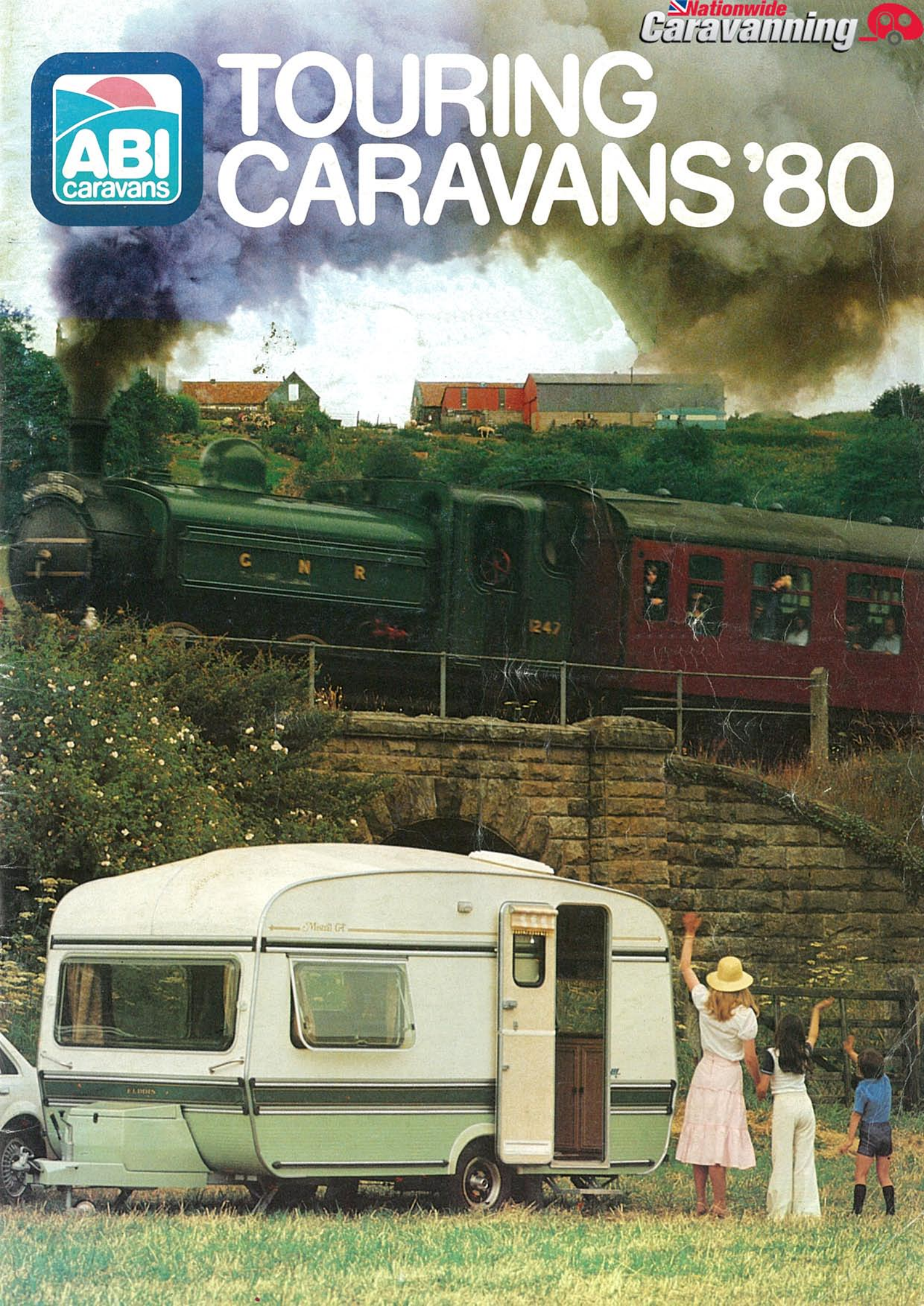

TOURING CARAVANS '80



INTRODUCTION



As a foreword to this years book it may be as well to cast an eye to the kind of world we are living in. Where fuel costs and increased V.A.T. may at first make you think hard about buying a caravan a second look will show you that air fares, hotels and so on won't escape the effects either.

In fact the 80's could see many new faces entering the world of caravans. It could be the one realistic way to take regular holidays or even more regular holiday weekends. Because, by comparison to other forms of holiday making caravanning is and will remain inexpensive.

In the next 60 pages, you will find a collection of caravans (36 of them in all, with several optional layouts) designed to satisfy the needs of a wide spectrum of holiday makers.

They all, however, have at least one thing in common.

They are all among the market leaders in their own particular segment of the market. Which is another way of saying they are all made by ABI Caravans.

If you're wondering just why those two statements mean the same thing, this introduction should give you several clues.

ABI Caravans Ltd., is owned by Ace Belmont International, a group which was formed in 1972 with the merger of two highly successful caravan companies.

The Ace Caravan Company (Hull) Ltd., who made a well-known range of high-quality touring caravans and the Belmont Caravan Company Limited — makers of an equally high-quality range of holiday homes.

Another well established company Eddis Caravans Ltd., became a member of the group in 1973. Their range of middle of the market tourers slotted in neatly to the models already being produced.

From that start ABI has become the largest manufacturer of touring caravans and holiday homes in the UK.

Without a doubt, the main reason for that rapid growth has been the sheer quality of the caravans we make.

They are all made by modern "Flow Line" production techniques. Sometimes using special techniques which are unique to ABI.

For instance, all the furniture inside is made, by us, to domestic standards. And, as an extra refinement, most of it is made by our unique V-grooving process which literally wraps the vinyl veneer around the wood. So there is less chance of loose edges on doors, shelves, etc., to peel, or lift, or rip.

Some more small examples of ABI's attention to detail is the fact that the end boards of all the beds has been raised to stop the bedding tumbling around when you're travelling. And there is a fitted doormat on every tourer, which can be taken out and shaken. Which should help stop you carrying dust and dirt all over the handsome fitted carpet.

Little things like that mean a lot. They make the difference between living in a caravan and living in comfort in a caravan. But you'd be surprised how many other manufacturers don't take that amount of trouble. On the outside, it's the same painstaking story. Let's start with the chassis for example.

It's made by B & B Trailers to ABI's own design and specification. It has a wide track and long drawbar for better roadholding, and easier towing. (By the way the A frame on the longer drawbar will hold two of the big Continental size gas bottles, as a bonus). It's fitted with radial ply tyres on 4½ J rims with distinctive wheel trims. It has Sigma II coupling and Lockheed autoreverse brakes. And then all tourer chassis are double painted to minimize the risk of rust.

All our 1980 models feature rear fog lights — after all, it will be a legal requirement after October, but we've fitted all models from the start of the 1980 production.

On top of all this care and attention to detail there's even more care and attention to detail.

Numerous quality control checks on the caravans as they move along the production line. Checked at every stage of assembly by an Inspector or Senior Manager.

Then everything is gas tested and all electrics are tested. That's done at the end of the production line before the caravan goes out of the factory door.

If that's not enough, your ABI Dealer then carries out a detailed inspection to double check everything before your caravan is ready to go on your holiday.

Speaking of dealers, brings us to another reason for ABI's success. That's the dealer network that covers nearly every major population area in the UK. Over 100 carefully selected dealers who are exclusively franchised to sell ABI Caravans and provide a complete back up service.

They'll provide you with the ultimate in after sales service and they hold a comprehensive stock of all the accessories a caravan owner could need. That's the kind of background that's behind every ABI caravan. All you have to do now is find the particular one that suits your particular needs.

THE ABI MONZA RANGE



For a first time buyer the ABI Monza range offers you more value for money than you could have possibly expected. From the word go, the off white exterior with maroon waist band and gold coach lines remind you that you're travelling first class.

When you look inside there'll be no reason to be disappointed either. Because, although Monza prices should satisfy the most cost conscious buyer, Monza standards



will satisfy the most quality conscious. This year we've given the Monza a hammered aluminium exterior which adds to its strength and appearance. And single glazed bronze tinted polyplastic windows are standard on all models. Starting with the largest, the Monza 1600 is the top model in the range. With an interior specification that more than matches its outward looks, few caravans offer the same value.

*Gas bottle locker extra.



MONZA



Just take a look. From the floor up — where there are genuine Kosset carpets — we've given it everything we can. This year, the upholstery is in a large floral design and the wood finishes to all the cupboards are pale woodgrain and accentuate the feeling of space. There's plenty of space inside them as well. Just how many are there? Well as many as you'll need. And they're designed to open easily when they should and not to open at all easily when you're travelling.

As with most features of the Monza, ABI pride themselves in providing value for money. A dinette that converts into two single beds with bunks above or a double bed. One way or the other it's going to be right. A kitchen with everything at hand when you need it, and out of sight when you don't.

In the Monza 1400S there's a rear double bed and single bunk above it. And new this year is an exciting 12ft two berth Monza — probably the only budget priced 2 berth tourer at this size available. It provides ideal accommodation for two people and the opportunity to add those little extras like a fridge, fire and oven when you want to give yourself more home comforts.

And in all models you can screen off the childrens beds with a handy curtain. As we said, one way or another, it has to be right.

If you want a lightweight caravan that's easy to tow and park, to take on a good traditional low cost holiday, it's the Monza. The Monza range consists of eight models from the compact 10ft Monza 1000 and 1000T to the 12ft Monza 1200S, 1200CT and new 1200/2, to the 1400S and 1400CT at 14ft to the top of the range Monza 1600. In other words a layout and a size to meet every need.

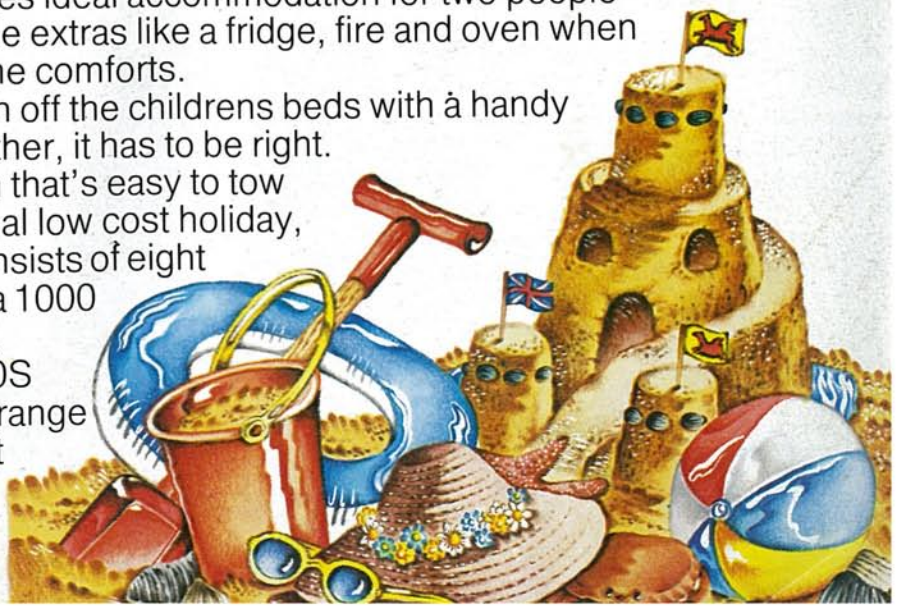

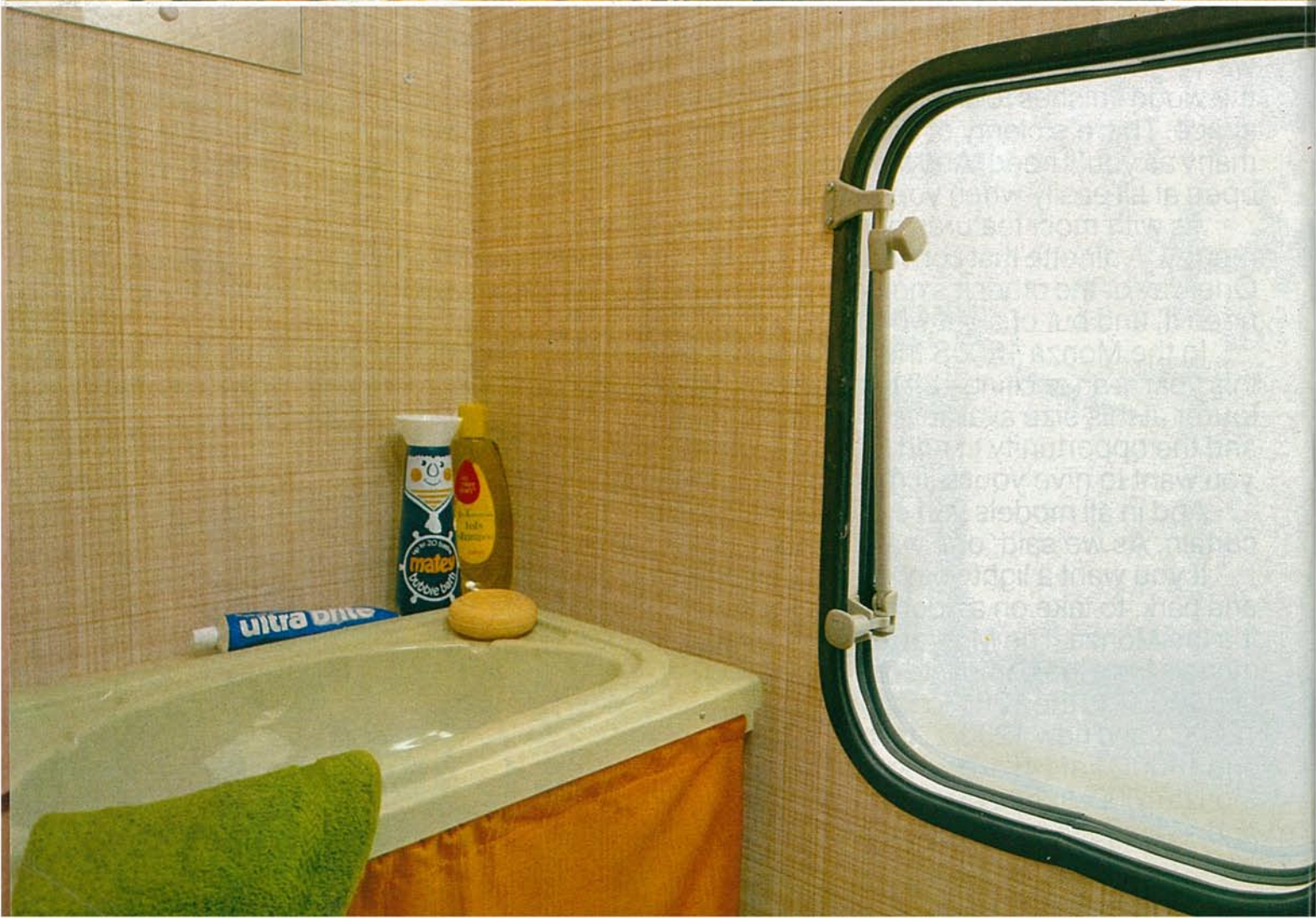

MONZA



ABI MONZA

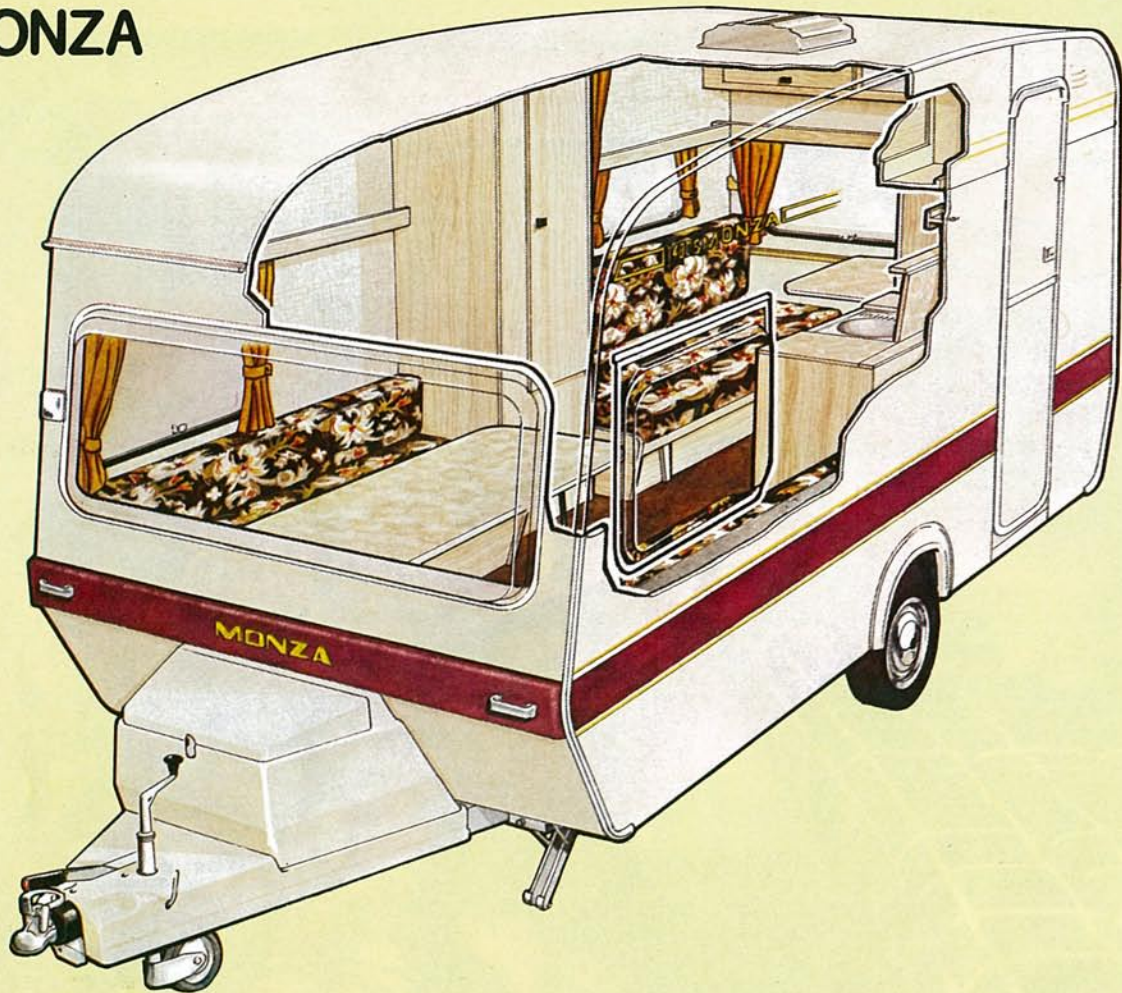

FACT SHEET

ABI MONZA	Body Length	Overall Length	Overall Width	Overall Height	Ex Works Weight	Gross Laden Weight
1000	3.33m/10'11"	4.35m/14'3"	2.06m/6'9"	2.39m/7'10"	550kg/10.82cwt	700kg/13.77wt
1000T	3.33m/10'11"	4.35m/14'3"	2.06m/6'9"	2.39m/7'10"	570kg/11.22cwt	715kg/14.07cwt
1200S	3.94m/12'11"	5.00m/16'5"	2.06m/6'9"	2.39m/7'10"	640kg/12.6cwt	813kg/16.00cwt
1200CT	3.94m/12'11"	5.00m/16'5"	2.06m/6'9"	2.39m/7'10"	640kg/12.6cwt	813kg/16.00cwt
1200/2	3.94m/12'11"	5.00m/16'5"	2.06m/6'9"	2.39m/7'10"	630kg/12.40cwt	787kg/15.5cwt
1400S	4.54m/14'11"	5.61m/18'5"	2.06m/6'9"	2.39m/7'10"	700kg/13.77cwt	888kg/17.48cwt
1400CT	4.54m/14'11"	5.61m/18'5"	2.06m/6'9"	2.39m/7'10"	680kg/13.38cwt	888kg/17.48cwt
1600	5.15m/16'11"	6.20m/20'4"	2.06m/6'9"	2.39m/7'10"	760kg/14.95cwt	965kg/19.00cwt

Note: All imperial figures are rounded up to the nearest inch. Every effort is made to ensure the accuracy of these statistics but they may vary depending upon conditions at the time of manufacture.

ABI MONZA Bed Sizes

1000	6'3" x 3'8" (D) 6'3" x 1'11" (S) 6'0" x 1'8" (HB)
1000T	5'10" x 4'1" (D) 6'3" x 1'11" (S) 6'0" x 1'8" (HB)
1200S	6'3" x 3'8" (D) 5'10" x 3'10" (D) 6'0" x 1'8" (HB)
1200CT	6'3" x 3'8" (D) 6'3" x 1'11" (S) 6'0" x 1'8" (HB)
1200/2	5'10" x 2'3" (2S) or 6'3" x 5'10" (D)
1400S	5'10" x 3'10" (D) 6'3" x 5'10" (D) or 5'11" x 2'3" (2S) 6'0" x 1'8" (HB)
1400CT	6'3" x 3'8" (D) 6'3" x 3'8" (D)
1600	6'3" x 3'8" (D) 6'3" x 5'10" (D) 6'0" x 1'8" (HB) or 5'10" x 2'3" (2S) 6'0" x 1'8" (HB)

Note: D—Double Bed, S—Single Bed, HB—Hammock Bunk.

MONZA upholstery may differ from that illustrated due to supply situation. Please check with your ABI dealer.

Standard features on all Monza caravans:

Single glazed polyplastic tinted windows, transistorised electric lighting, fitted carpets, high quality upholstery and curtains, preformed plastic front panel, radial tyres, Sigma back-up system, Formica work surfaces and table coverings, stable door, acrylic pre-painted hammered aluminium panelling, full awning channel, PVC-faced plywood wall panelling, gas light, independent suspension, full frame steel channel chassis, telescopic

jockey wheel, gas cylinder carrier, preformed plastic rear panel enclosing road lights, triangular red reflectors, two seven-pin electrical connectors, continual flow ventilation, roof light, door mat and rear fog lights. Factory fitted optional extras: Fridge, oven, polyplastic sealed tinted double glazed windows, underfloor insulation, gas heater, gas bottle locker and fairing to hold two 15lb. bottles.

- A Dinette/Double Bed.
- B Dinette/Single Bed with Bunk over.
- C Single Bed.
- D Settee/Single Bed with Bunk over.
- E Double Bed with Bunk over.
- F Cupboard.
- G Table.
- H Hotplate and Grill.
- J Stainless Steel Sink Unit.
- K Wardrobe.
- M Wall Locker.
- N Shelf.
- O Toilet.
- P Roof Light.
- Q Dividing Curtains.

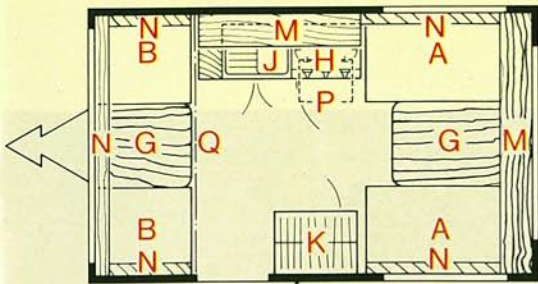

ABI MONZA 1000. 4 BERTH

Front single dinette (single bed with bunk over), rear double dinette (double bed), centre kitchen with stainless steel sink and two burner/grill cooker, foot operated water pump and ample wardrobe cupboard and locker storage space.

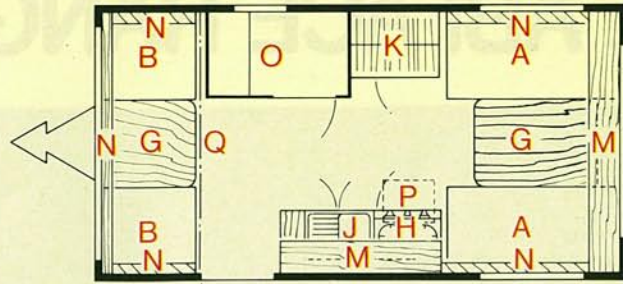

ABI MONZA 1200CT. 4 BERTH

Front single dinette (single bed with bunk over), rear double dinette (double bed) centre toilet compartment, wash hand basin, centre kitchen with stainless steel sink, two burner/grill cooker, foot operated water pump, ample cupboard, locker and wardrobe storage space.

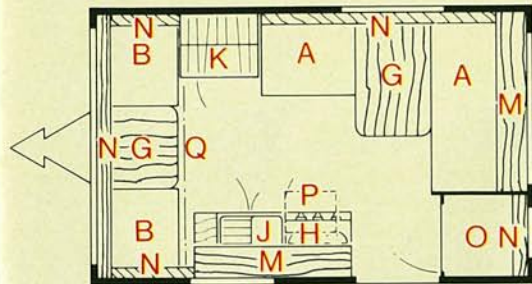

ABI MONZA 1000T. 4 BERTH

Front single dinette (single bed with bunk over), rear L-shaped dinette (double bed), end toilet compartment, centre kitchen with stainless steel sink and two burner grill/cooker, foot operated water pump, ample cupboard, locker and wardrobe storage space.

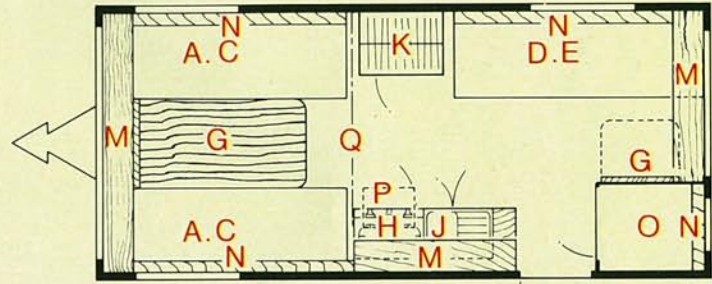

ABI MONZA 1400S. 5 BERTH

Front king size dinette (large double or two single beds), rear settee (pull out double bed with bunk above), flap-up table, end toilet compartment, centre kitchen with stainless steel sink, two burner/grill cooker, foot operated water pump, ample cupboard, locker and wardrobe storage space.

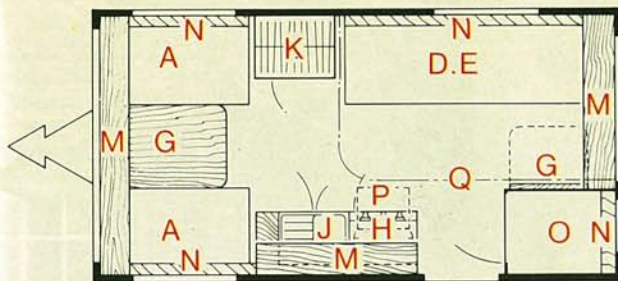

ABI MONZA 1200S. 5 BERTH

Front double dinette (double bed), rear settee (double bed with bunk over), flap-up table, end toilet compartment, centre kitchen with stainless steel sink, two burner/grill cooker, foot operated water pump, ample cupboard, locker and wardrobe storage space.

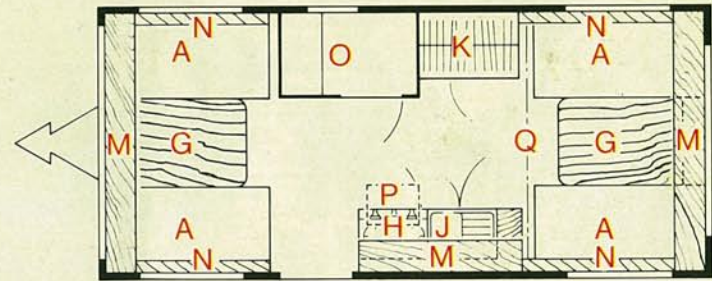

ABI MONZA 1400CT. 4 BERTH

Front dinette (double bed), rear double dinette (double bed), centre toilet compartment, wash hand basin, centre kitchen with stainless steel sink, two burner/grill cooker, foot operated water pump, ample cupboard, locker and wardrobe storage space.

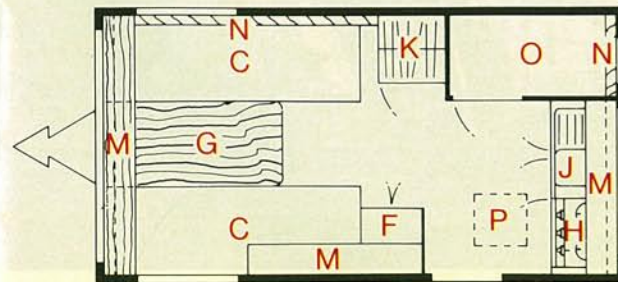

ABI MONZA 1200. 2 BERTH

Front king size dinette (large double or two single beds) end toilet compartment and kitchen with stainless steel sink and two burner/grill cooker, foot operated water pump, ample cupboard, wardrobe and locker storage space.

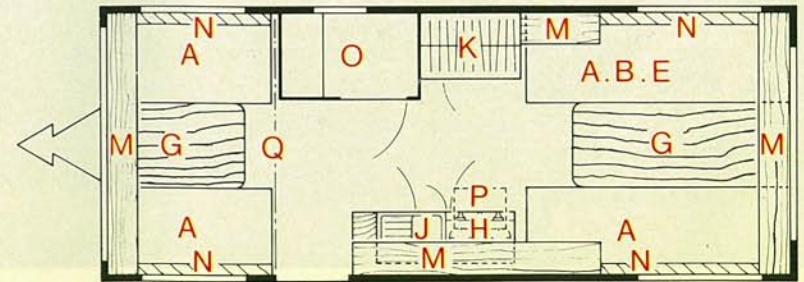

ABI MONZA 1600. 5 BERTH

Front dinette (double bed), rear king size dinette (two singles or double bed with bunk over), centre kitchen with two burner/grill cooker, foot operated water pump, centre toilet compartment with wash hand basin, ample cupboard, locker and wardrobe storage space.

THE ABI ACE RANGE



Perhaps you'll see more of the ABI Ace range of caravans around our countryside than almost any other tourer. And with good reason. Every year we produce a wide selection of Aces to cater for almost everyone's needs. And every year we try to give a little more value than we did last.

In this year's range there are eight models from the 11ft Ace Diplomat to the top of



the range Ace Viceroy. Where we've upgraded, we've almost upgraded to the level of appointment in last year's top of the line Award.

Outside, you'll see they have been restyled with the addition of tinted polyplastic windows. They have an attractive glaze (cream) exterior colour scheme and new aluminium waste moulds and gold coach lines. Inside . . . well turn over and see.





On these pages you can see the Ace Ambassador — it's our top selling mid-range model. The upholstery has been upgraded this year, the carpet is sculptured pile and as you can see the interior doors to cupboards and closets are all panelled.

We've included 22mm polystyrene insulation between the walls so if it looks warm and cosy in there, it's because it is. (Naturally it has the opposite effect when it's baking outside.) If you cast your eye over to the kitchen you'll see a very large fridge. It's an Electrolux 212 and it's fitted as standard in all Aces this year.

The Ace Rallyman featured on the next two pages is a two berth caravan with everything down to a 12 volt lighting system and electric water pump. It has a front double dinette which converts into either one double or two single beds. Or you can change the layout to include a side instead of a centre table. It has all the new Ace features including single glazed tinted acrylic windows and domestic quality furnishings.

Next we see the Viceroy — top of the Ace range. The extra couple of feet it has over the Ambassador in body length has given us a lot more room inside. In the centre there's a large kitchen area with room for a full sized cooker as well as tons of cupboard space. Opposite, is a centre toilet and wash room with plenty of room for a chemical toilet. At the front, there's a double dinette which quickly becomes a double bed with the option of a bunk over the top, and the whole section screens off neatly so the early risers can shut themselves away from the late nighters. They can turn the dinette at the end into two singles when they're ready.

In these pages we have illustrated a few of the popular Ace range which consists of the Diplomat (11ft) and Rallyman (13ft) 2 berth models, the Globetrotter (13ft), Orbit (13ft), Harmony (13½ft), Ambassador (15ft), Courier (15ft 9in) and Viceroy (16ft 6in) four berth models.

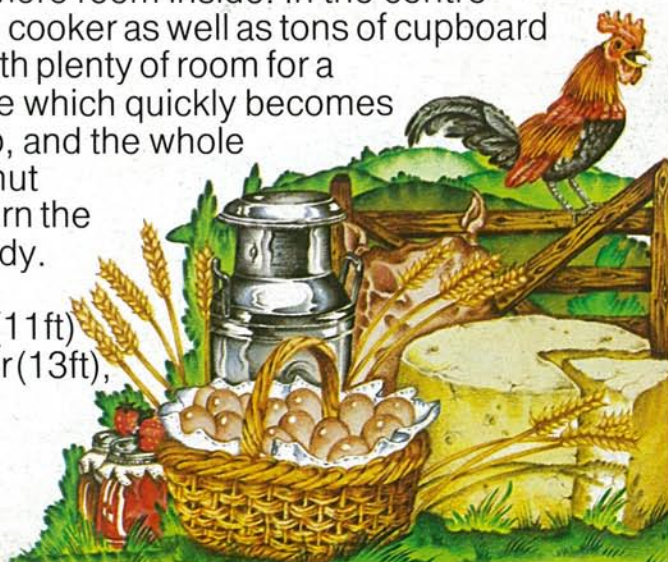



ACE







ABI ACE

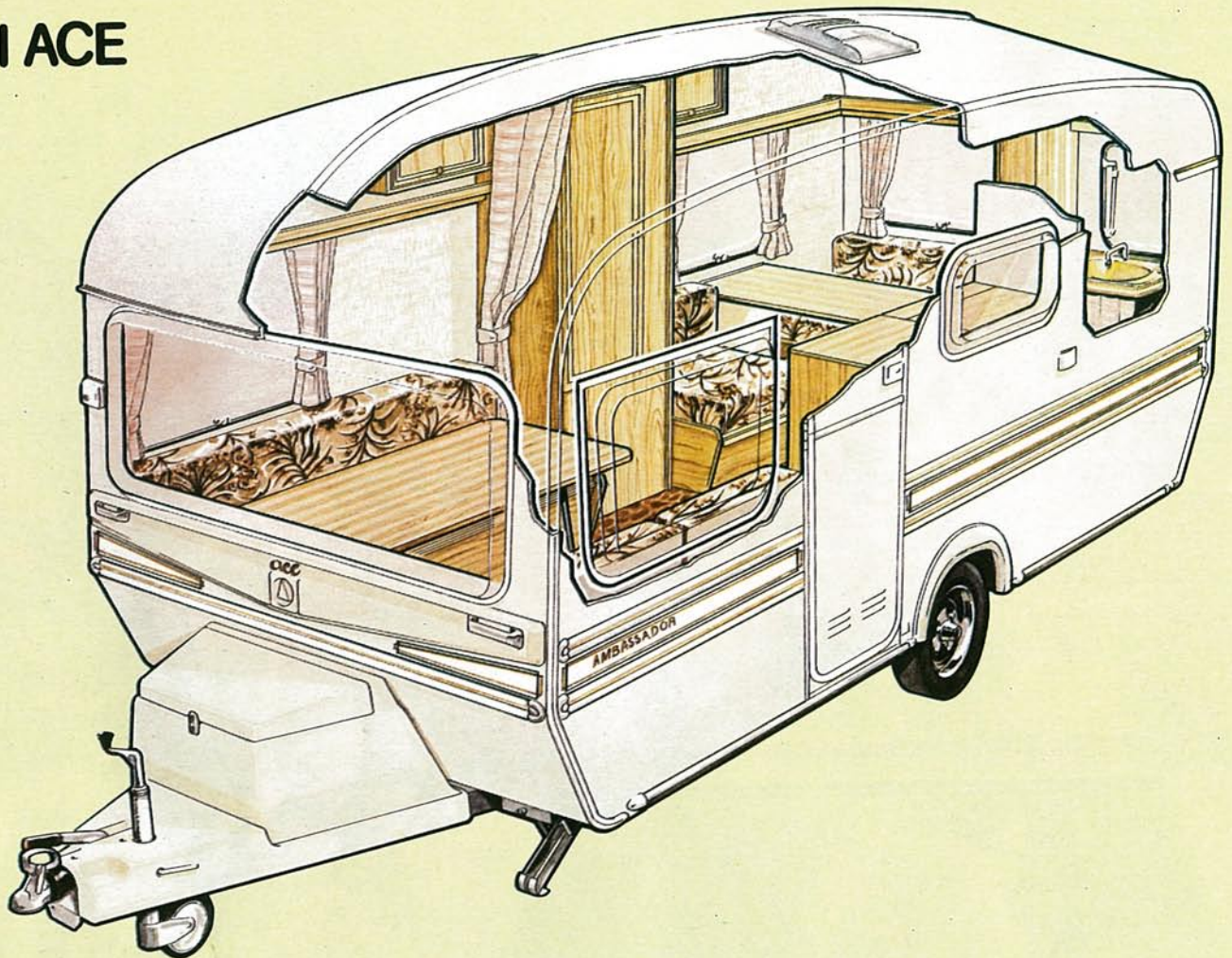

FACT SHEET

ABI ACE	Body Length	Overall Length	Overall Width	Overall Height	Ex Works Weight	Gross Laden Weight
Diplomat	3.43m/11'3"	4.45m/14'7"	2.08m/6'10"	2.44m/8'00"	630kg/12.40cwt	787kg/15.5cwt
Globetrotter	3.96m/13'00"	4.97m/16'4"	2.08m/6'10"	2.46m/8'1"	680kg/13.39cwt	876kg/17.25cwt
Rallyman	3.96m/13'00"	4.97m/16'4"	2.08m/6'10"	2.41m/7'11"	680kg/13.39cwt	852kg/16.77cwt
Orbit	3.96m/13'00"	4.95m/16'3"	2.08m/6'10"	2.41m/7'11"	660kg/12.99cwt	868kg/17.08cwt
Harmony	4.11m/13'6"	5.13m/16'10"	2.08m/6'10"	2.41m/7'11"	690kg/13.58cwt	888kg/17.48cwt
Ambassador	4.54m/14'11"	5.57m/18'3"	2.08m/6'10"	2.46m/8'1"	720kg/14.17cwt	983kg/19.35cwt
Courier	4.85m/15'11"	5.87m/19'3"	2.08m/6'10"	2.46m/8'1"	800kg/15.75cwt	1021kg/20.10cwt
Viceroy	5.08m/16'8"	6.10m/20'00"	2.08m/6'10"	2.46m/8'1"	830kg/16.34cwt	1032kg/20.31cwt

Note: All imperial figures are rounded up to the nearest inch. Every effort is made to ensure the accuracy of these statistics but they may vary depending upon conditions at the time of manufacture.

ABI ACE Bed Sizes

Diplomat	6'4" x 4'00" (D) or 5'11" x 2'3" (2S)
Globetrotter	6'4" x 3'9" (D) 5'11" x 4'00" (D)
Rallyman	6'4" x 5'11" (D) or 5'11" x 2'3" (2S)
Orbit	6'4" x 3'9" (D) 6'4" x 2'3" (S) 6'00" x 1'8" (HB)
Harmony	6'4" x 3'9" (D) 5'11" x 2'3" (S) 5'11" x 1'10" (B)
Ambassador	6'4" x 3'11" (D) or 5'11" x 2'3" (2S) 5'11" x 4'00"
Courier	6'4" x 4'1" (D) 5'11" x 3'10" or 5'11" x 2'2" (S) 5'11" x 1'10" (B)
Viceroy	6'4" x 3'9" (D) 6'4" x 5'11" or 5'11" x 2'3" (2S)

Note: D—Double Bed, S—Single Bed, B—Sprung Bunk, HB—Hammock Bunk.

- A Dinette/Double Bed.
- B Dinette/Single Bed with Bunk over.
- C Single Bed.
- D Settee/Single Bed with Bunk over.
- F Cupboard.
- G Table.
- H Hotplate and Grill.
- I Full Cooker.
- J Stainless Steel Sink Unit.
- K Wardrobe.
- L Chest of Drawers.
- M Wall Lockers.
- N Shelf.
- O Toilet with Vanity unit.
- P Roof Light.
- Q Dividing Curtains.
- U Fridge.

Standard features on all Ace Tourers: Tinted single glazed polyplastic windows, top quality upholstery, continual flow ventilation, roof light, stone guard front panel, gas bottle locker and fairing for two 15lb gas bottles, radial ply tyres, independent suspension, full frame steel channel chassis, Sigma back-up system, opening roof lights, two seven-pin electrical connectors, full awning channel, acrylic pre-painted aluminium panelling, PVC faced plywood interior wall

panelling, gas lights, polystyrene insulation, 12 volt fluorescent light, deep windows, stable door, fitted carpets, Formica work surfaces and table coverings, door mat, 2 cu. ft. fridge (1.2 cu. ft. in the Diplomat) fog lights.

Factory fitted optional extras: Oven (standard in Viceroy), sealed tinted polyplastic tinted windows, gas heater (excluding Diplomat), folding step. Optional layouts as covered in model specifications.

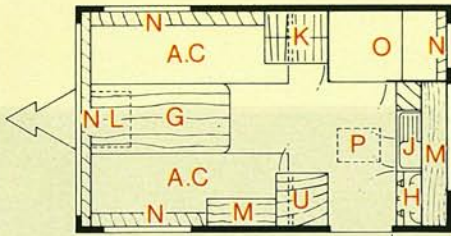

ABI ACE DIPLOMAT. 2 BERTH

Front king-size dinette (Large double or two single beds), end kitchen with stainless steel sink and two burner/grill cooker, dual manual/electric water pump, end toilet compartment with wash hand basin, chest of drawers, ample wardrobe, cupboard and locker storage space, fridge.

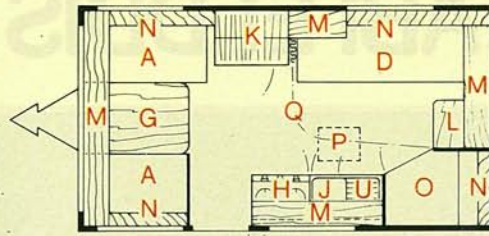

ABI ACE HARMONY. 4 BERTH. (Optional 5 berth)

Front double dinette (double bed), rear settee (single or optional pull out double bed with bunk over), flap-up rear table, centre kitchen with stainless steel sink and two burner/grill cooker, dual manual/electric water pump, large end toilet compartment with wash hand basin, ample wardrobe, locker and cupboard storage space, fridge.

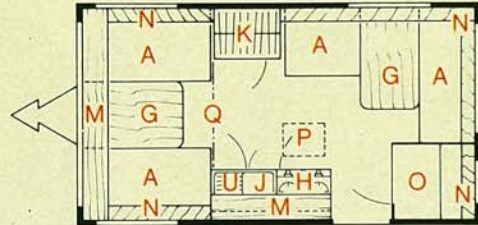

ABI ACE GLOBETROTTER. 4 BERTH

Front double dinette (double bed). Rear L-shaped dinette (double bed). centre kitchen with stainless steel sink and two burner/grill cooker, dual manual/electric water pump, end toilet compartment with wash hand basin, ample cupboard, locker and wardrobe storage space, fridge.

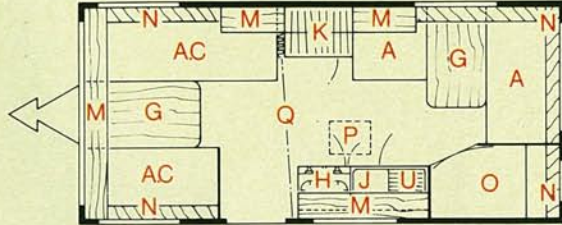

ABI ACE AMBASSADOR. 4 BERTH

Front double dinette (two single or one double bed), rear L-shaped dinette (double bed), centre kitchen with stainless steel sink and two burner/grill cooker, dual manual/electric water pump, end toilet compartment with wash hand basin, ample cupboard, wardrobe and locker storage space, fridge.

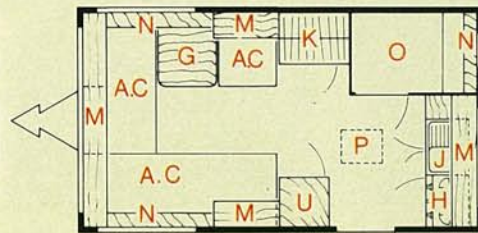

ABI ACE RALLYMAN. 2 BERTH

Front king-size dual layout dinette (large double or two single beds), end kitchen with stainless steel sink and two burner/grill cooker, dual manual/electric water pump, end toilet with wash hand basin, ample cupboard, wardrobe and locker space, fridge.

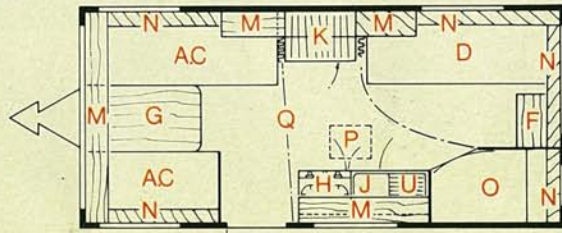

ABI ACE AMBASSADOR. 4 BERTH. (Optional layout)

Front double dinette (two single or one double bed), rear settee (single bed with bunk over), centre kitchen with stainless steel sink and two burner/grill cooker, dual manual/electric water pump, end toilet compartment with wash hand basin, ample cupboard, locker and wardrobe storage space, fridge.

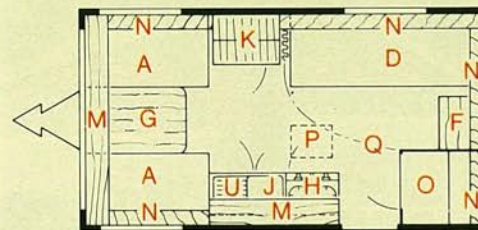

ABI ACE GLOBETROTTER. PIONEER. 4 BERTH (Optional layout)

Front double dinette (double bed), rear settee (single bed with bunk above), centre kitchen with stainless steel sink and two burner/grill cooker, dual manual/electric water pump, end toilet compartment with wash hand basin, ample cupboard, locker and wardrobe storage space, fridge.

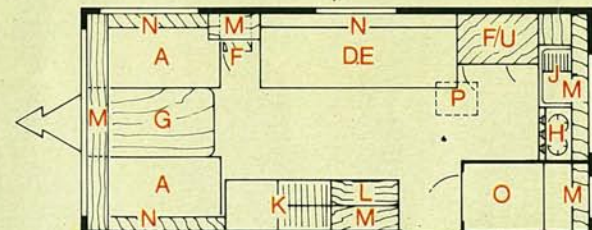

ABI ACE COURIER. 4 BERTH. (Optional 5 berth)

Front double dinette (double bed), centre settee (single or optional pull out double bed with bunk over), end L-shaped kitchen with stainless steel sink and two burner/grill cooker, dual manual/electric water pump, end toilet compartment with wash hand basin, ample cupboard, wardrobe and locker storage space, fridge.



ABI ACE ORBIT. 4 BERTH

Front double dinette (double bed) rear single dinette (single bed with bunk over), centre kitchen with a stainless steel sink and two burner/grill cooker, dual manual/electric water pump, ample wardrobe, cupboard and locker storage space, centre toilet compartment, fridge.

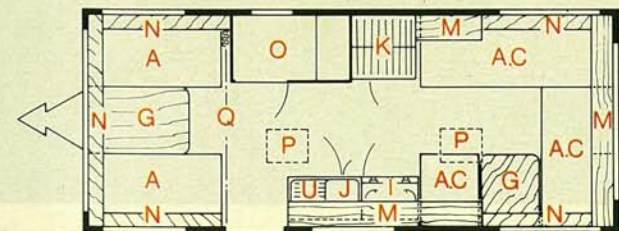

ABI ACE VICEROY. 4 BERTH. (Optional 5 berth)

Front double dinette (double bed with optional bunk over), rear king-size dual layout dinette (two single beds), centre kitchen with stainless steel sink, two burner/grill cooker and oven, dual manual/electric water pump, centre toilet compartment with wash hand basin, ample cupboard, wardrobe and locker storage space, fridge.

THE ABI ELDDIS RANGE

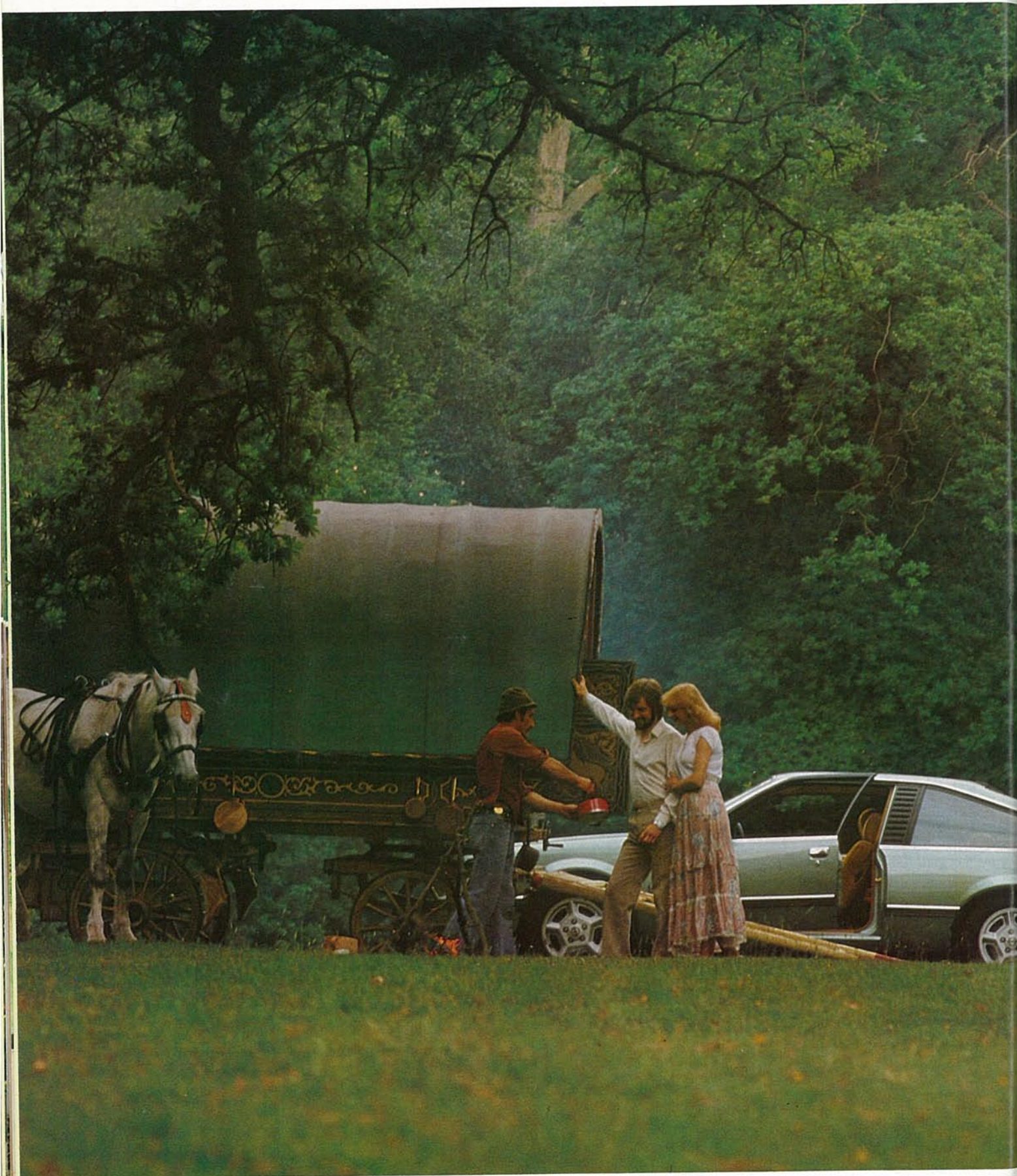

For the clubman caravanning is a way of life. Perhaps almost as much a way of life as the gypsy caravan is to the old timer in the picture. And for most average clubmen — with above average tastes in style and performance — Elddis is the range they always seem have made a beeline for. With the introduction of the new Elddis GT range this year we see no reason why anything should change. Thumb through the next few pages and



you'll see it's as modern in design and function as is the horse drawn caravan antiquated. Yet it will never lose the fundamental charm of caravanning. "I'm a freeborn man of the travelling people" so an old rovers song goes. And if that's the feeling you want the Elddis range isn't going to disappoint you. Being at home on the road is what it's all about.





The Eddis is as much like home as you could want. Heavy brocade furnishings, sculptured pile carpets where does it end? It doesn't.

The kitchen has a 2 cu.ft. fridge as standard, cupboards galore and a two burner/grill cooker, stainless steel sink and piped water.

And when it comes to privacy the wash room area is more compactly designed and neatly tucked away than any you'd find. With wall coverings that we decorated as tastefully as the bathroom at home.

In an Eddis you could travel the country, gaze at the verdant woods and meadows through it's green tinted windows and feel you had everything you needed in this world right there with you. And why not, you have. That's provided of course there's only two of you. Should you have a family right there with you as well, the Eddis range is the obvious answer. They all have the same degree of refinement in either a four or six berth format.

On the next page we feature the top of the range Sirocco, which also has a standard oven as well as a fridge in the kitchen. At the front there's a family sized dinette which converts into two singles or a double bed. In the centre there's a settee with a single bunk above it. Naturally there's a safetyrail. And of course the renowned radius corners on all the furniture, which is a feature of the Eddis range, is a boon where child safety is concerned. The Sirocco also has more than enough storage space and wardrobes for any family.

So there's no way in an ABI Eddis the family need cramp your sense of freedom.

As we said, the Eddis really is the Clubman's caravan.

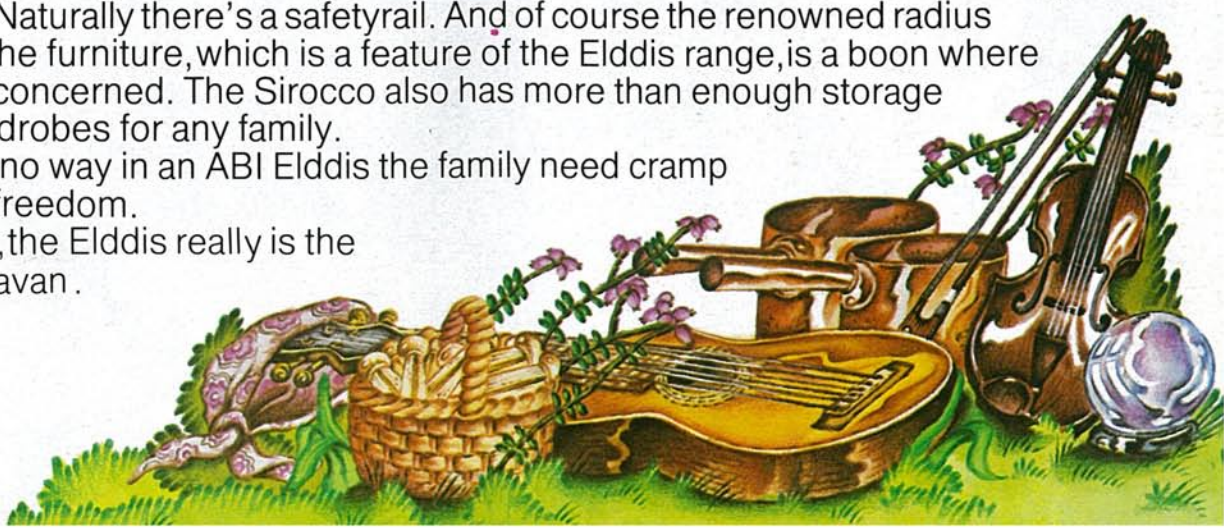









If the Eddis is the Clubman's caravan what is there left to move up to?
Except this.

The Eddis GT range. Here we see the Mistral GT, just one of three new models in the new Eddis GT range for 1980. The other two are the Tornado GT and the Shamal GT. All three models utilise the same layout as the standard models, but there the similarity ends.

It's quiet two tone green exterior and gold coach lines give a subtle indication that these are the ultimate GT touring caravans.

To give you an idea of how different they are these pages feature the Mistral GT model. It has just about all you could want without ever becoming ostentatious. Just fold down the doorstep (it goes clunk not click) and step inside.

Throughout, the wood work is the traditional Eddis light oak finish with curved safety edges, but all the furniture has decorative beading and antique style handles.

The upholstery is deep buttoned brocade which is probably equal in quality to the suite of furniture you'd buy for your best living room. The carpet is deep pile and there's double glazed green tinted polyplastic windows all round.

In the kitchen the fridge and oven cooker are standard equipment as is the extractor hood above the cooker. And there's piped water in the kitchen and toilet.

Through the lounge there are more cupboards than there are in the basic Eddis plus a cocktail cabinet and there's a large chest of drawers between the two single beds in the Mistral.

Reading lights and a gas fire are two more standard fittings. They, and the rest of the electric equipment, can work from the mains electric 12 volt/240 watt transformer as well as the car battery.

Such is the refinement of the GT range.

The GT range has been designed for the confirmed Eddis Clubman who wants all the extras of life as standard, but still wants to buy an Eddis. Now this is possible.

ABI ELDDIS

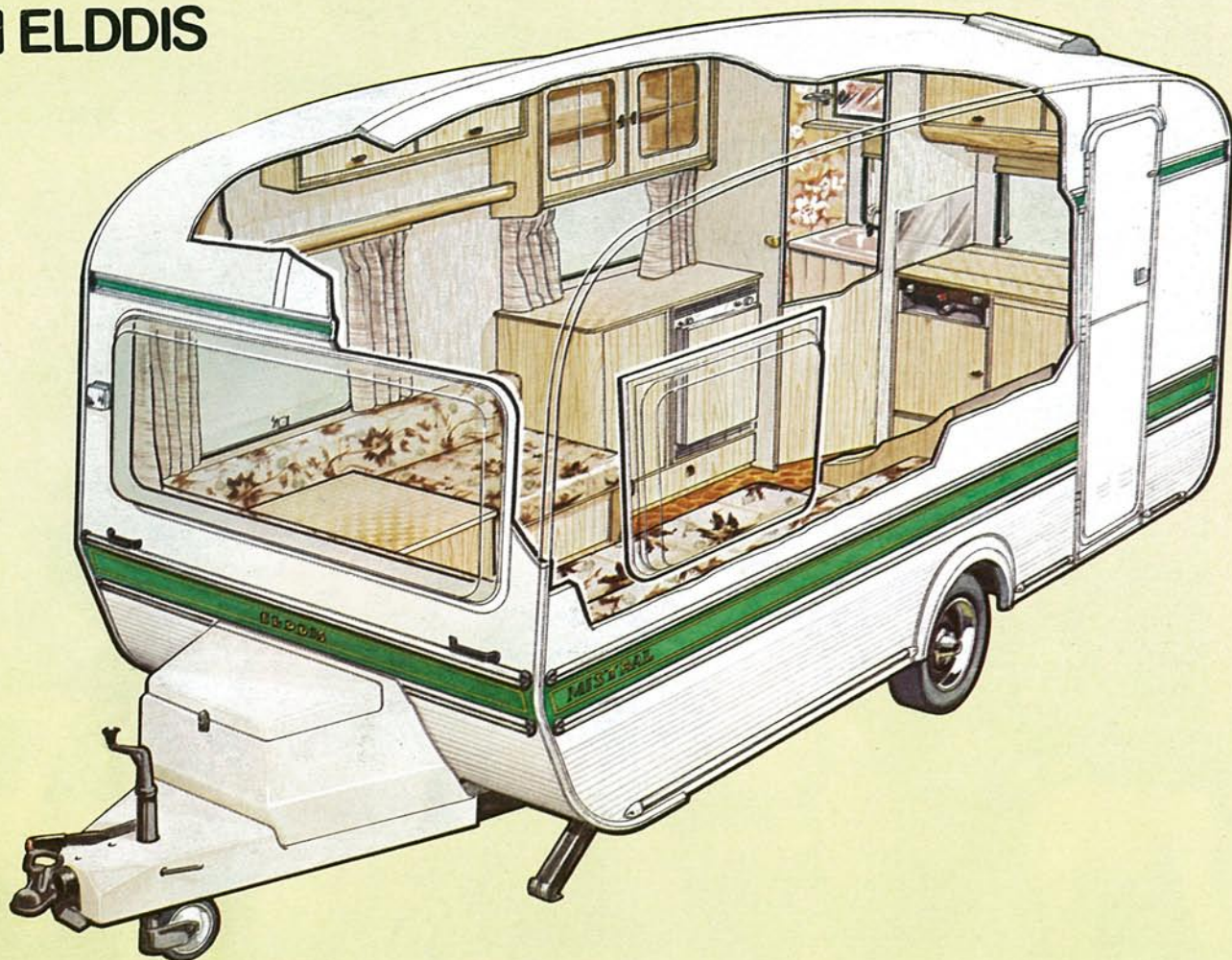

FACT SHEET

ABI ELDDIS	Body Length	Overall Length	Overall Width	Overall Height	Ex Works Weight	Gross Laden Weight
Whirlwind	3.58m/11'9"	4.65m/15'3"	2.10m/6'11"	2.48m/8'2"	640kg/12.59cwt	800kg/15.74cwt
Mistral	4.04m/13'3"	5.10m/16'9"	2.10m/6'11"	2.46m/8'1"	695kg/13.68cwt	888kg/17.48cwt
Tornado	4.04m/13'3"	5.10m/16'9"	2.10m/6'11"	2.48m/8'2"	665kg/13.09cwt	888kg/17.48cwt
Cyclone	4.52m/14'10"	5.57m/18'3"	2.10m/6'11"	2.54m/8'4"	734kg/14.44cwt	934kg/18.50cwt
Shamal	4.49m/14'9"	5.53m/18'2"	2.10m/6'11"	2.51m/8'3"	720kg/14.17cwt	934kg/18.50cwt
Sirocco	5.13m/16'10"	6.14m/20'2"	2.10m/6'11"	2.48m/8'2"	842kg/16.58cwt	1067kg/21.00cwt
Mistral GT	4.06m/13'4"	5.10m/16'9"	2.10m/6'11"	2.44m/8'0"	808kg/15.92cwt	965kg/19.00cwt
Tornado GT	4.04m/13'3"	5.10m/16'9"	2.10m/6'11"	2.48m/8'2"	780kg/15.33cwt	958kg/18.85cwt
Shamal GT	4.49m/14'9"	5.53m/18'2"	2.10m/6'11"	2.51m/8'3"	835kg/16.42cwt	1011kg/19.90cwt

Note: All imperial figures are rounded up to the nearest inch. Every effort is made to ensure the accuracy of these statistics but they may vary depending upon conditions at the time of manufacture.

ABI ELDDIS Bed Sizes

Whirlwind	6'1" x 2'3" (S) or 5'8" x 2'3" (S) or 6'4" x 4'4" (D)
Mistral	6'5" x 2'3" (2S) or 6'4" x 5'0" (D)
Tornado	6'4" x 4'2" (D) 6'2" x 2'2" (S) 6'0" x 1'11" (B)
Cyclone	6'4" x 4'1" (D) or 6'2" x 2'3" (2S)
Shamal	6'4" x 4'1" (D) 6'3" (S) 6'0" x 1'11" (B)
Sirocco	6'2" x 2'3" (2S) or 6'4" x 4'9" (D) 6'0" x 2'3" (S) 6'0" x 1'10" (B)
Mistral GT	6'6" x 2'3" (2S) or 6'4" x 5'0" (D)
Tornado GT	6'4" x 4'2" (D) 6'2" x 2'2" (S) 6'0" x 1'11" (B)
Shamal GT	6'4" x 4'1" (D) 6'3" (S) 6'0" x 1'11" (B)

Note: S—Single Bed, D—Double Bed, PB Pullman Bunk.

ELDDIS G.T. RANGE

The layouts on all G.T. models are the same as their counterparts in the basic range.

G.T. models are fitted with a folding step, green tinted double glazing, oven, reading lights, moulded panel woodwork, extra thick upholstery, two tone exterior paintwork, 220/240v battery charging unit, and gas heater, cooker hood and external awning light, door window, skylight with fly screen, bed locker drawers.

Standard features on all Elddis Caravans: single glazed polyplastic tinted windows, gas bottle locker and fairing for two 15lb. bottles, transistorised electric lighting, fitted carpets, pinch-pleated curtains, high quality upholstery, deep windows, radial ply tyres, Sigma back-up system, independent suspension, full insulation, full frame steel channel chassis, opening roof light, full road lights, fog lights, two 7 pin electrical connector full awning channel, acrylic pre-painted aluminium panelling, PVC faced plywood interior wall panelling, gas light, Formica work surfaces, 2 cu. ft. fridge, door mat, cocktail cabinet, vanity unit in toilet. Factory Fitted Optional Extras on Basic Models: Oven (standard in Sirocco Polyplastic tinted sealed double glazed windows, gas heater, fold-down step Optional layouts as in model specifications.

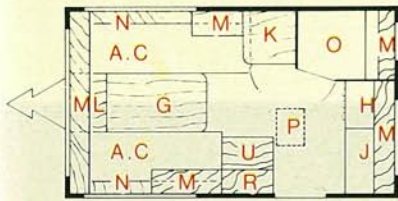

ABI ELDDIS WHIRLWIND. 2 BERTH

Front king size double dinette (large double or two single beds), end kitchen with stainless steel sink, two burner/grill cooker, dual manual/electric water pump end toilet compartment, with wash hand basin, chest of drawers, ample cupboard, locker and wardrobe storage space.

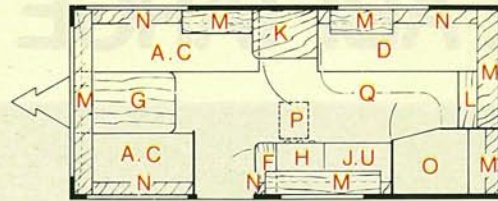

ABI ELDDIS CYCLONE. 4 BERTH (Optional 5 berth)

Front double dinette (double or two single beds), rear settee (single bed with upholstered bunk and safety rail), end toilet compartment with wash hand basin, centre kitchen with stainless steel sink, two burner/grill cooker, dual manual/electric water pump, ample cupboard, locker and wardrobe storage space.

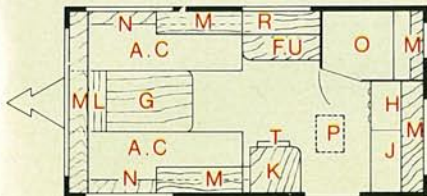

ABI ELDDIS MISTRAL. 2 BERTH

Slightly larger than the Whirlwind with front king-size double dinette (large double or two single beds), end kitchen with stainless steel sink and two burner/grill cooker, dual manual/electric water pump, end toilet compartment with wash hand basin, chest of drawers, ample wardrobe, locker and cupboard storage space.

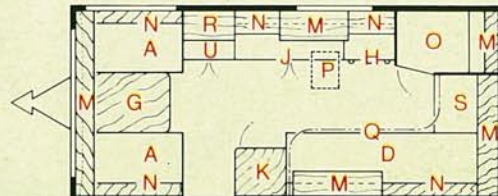

ABI ELDDIS SHAMAL. 4 BERTH

Front dinette (double bed), rear settee (single bed with upholstered bunk with safety rail), end toilet compartment with wash hand basin, centre kitchen with stainless steel sink, two burner/grill cooker, dual manual/electric water pump, ample cupboard, locker and wardrobe storage space.

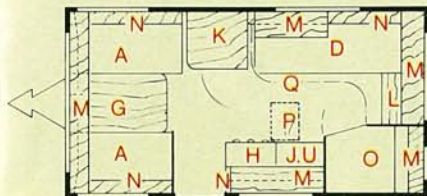

ABI ELDDIS TORNADO. 4 BERTH (Optional 5 berth)

Front double dinette (double bed), rear settee (single bed with upholstered bunk and safety rail), end toilet compartment with wash hand basin, centre kitchen with stainless steel sink, two burner/grill cooker, dual manual/electric water pump, ample cupboard, wardrobe and locker storage space.

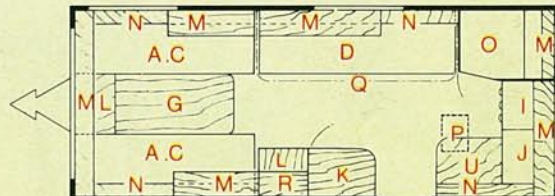

ABI ELDDIS SIROCCO. 4 BERTH (Optional 6 berth)

Front king size dinette (two single beds), centre settee (single bed with upholstered bunk and safety rail), end toilet compartment with wash hand basin, end kitchen with stainless steel sink, two burner/grill cooker, oven, dual manual/electric water pump, two chests of drawers, ample cupboard, locker and wardrobe storage space.

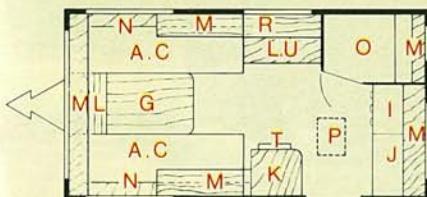

ABI ELDDIS MISTRAL G.T. 2 BERTH

Front king size double dinette (large double or two single beds), end kitchen with stainless steel sink, two burner/grill cooker, dual manual/electric water pump end toilet compartment, with wash hand basin, chest of drawers, ample cupboard, locker and wardrobe storage space.



ABI ELDDIS TORNADO G.T. 4 BERTH (Optional 5 berth)

Front double dinette (double bed), rear settee (single bed with upholstered bunk and safety rail), end toilet compartment with wash hand basin, centre kitchen with stainless steel sink, two burner/grill cooker, dual manual/electric water pump, ample cupboard, wardrobe and locker storage space.

- A Dinette/Double Bed.
- B Dinette/Single Bed with Bunk over.
- C Single Bed.
- D Settee/Single Bed with Bunk over.
- E Double Bed.
- F Cupboard.
- G Table.
- H Hotplate and Grill.
- I Full Cooker.
- J Stainless Steel Sink Unit.
- K Wardrobe.
- L Chest of Drawers.
- M Wall Locker.
- N Shelf.
- O Toilet with Vanity Unit.
- P Roof Light.
- Q Dividing Curtains.
- R Cocktail Cabinet and Crockery Locker.
- S Day Seat.
- T Heater.
- U Fridge.

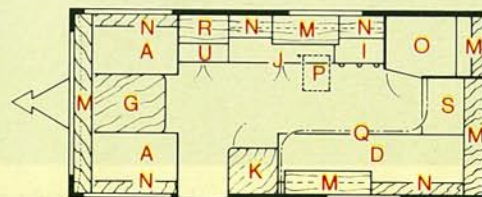

ABI ELDDIS SHAMAL G.T. — 4 BERTH

Front dinette (double bed), rear settee (single bed with upholstered bunk with safety rail), end toilet compartment with wash hand basin, centre kitchen with stainless steel sink, two burner/grill cooker, dual manual/electric water pump, chest of drawers, ample cupboard, locker and wardrobe storage space.

THE ABI TARGET RANGE



New and exciting, with a continental flavour — that's the Target range of tourers for 1980.

Completely restyled outside with a two tone hammered aluminium finish, the inside is pure unashamed luxury with matching and blending brown fabrics.

And top of the range is the new Target 5.70 the first production twin-axle tourer to



come out of ABI. Broadly based on the special model produced for world motor cycle star Barry Sheene, it must rank as one of the most exciting large tourers on the market throughout Europe this year.

Designed for the family looking for that individual style different from the crowd, the four model Target range must come top of the list.









ABI TARGET

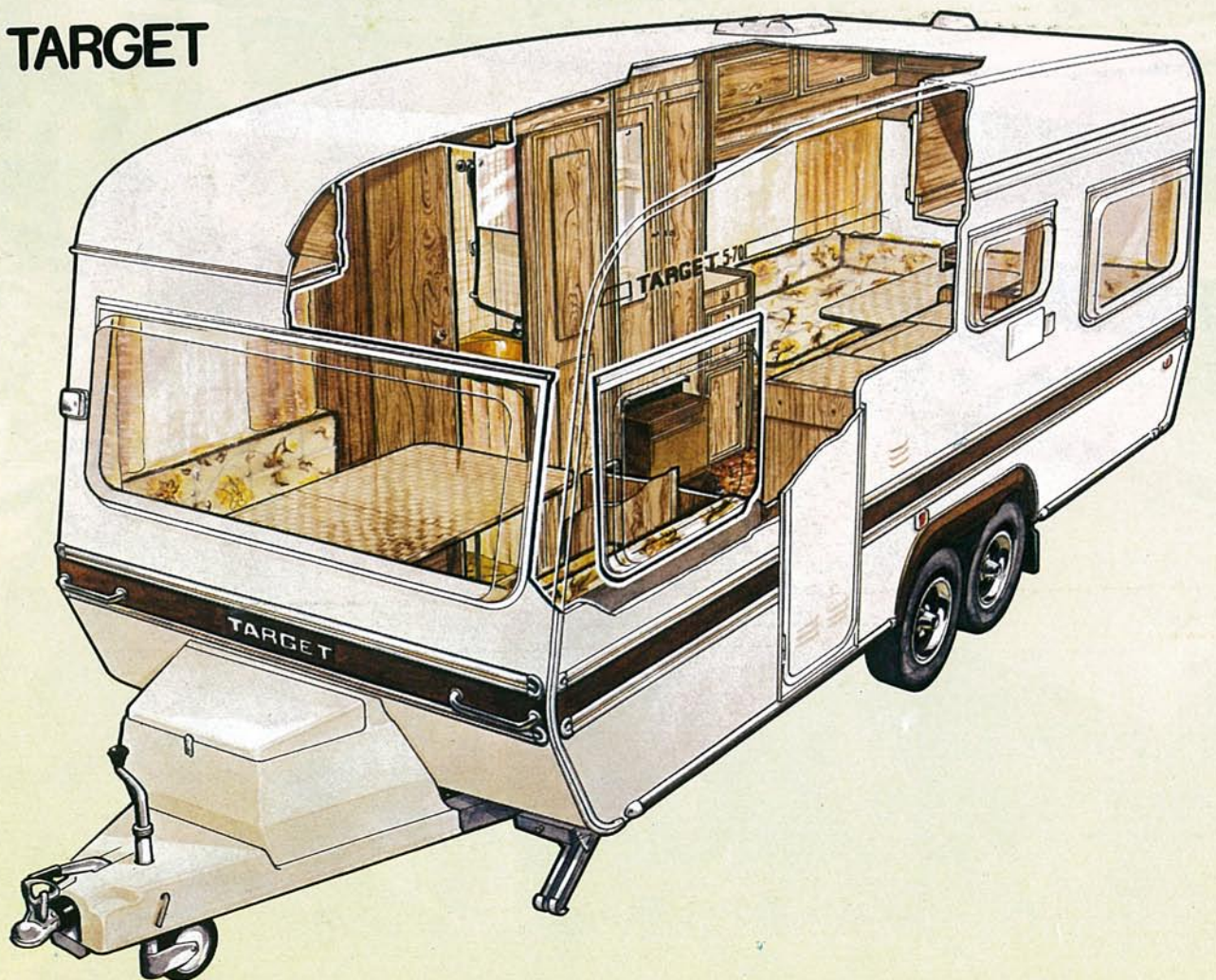

FACT SHEET

ABI TARGET	Body Length	Overall Length	Overall Width	Overall Height	Ex Works Weight	Gross Laden Weight
3.90	3.96m/13'0"	4.99m/16'4"	2.06m/6'9"	2.39m/7'10"	726kg/14.29cwt	930kg/18.3cwt
4.50	4.55m/15'0"	5.59m/18'4"	2.06m/6'9"	2.39m/7'10"	806kg/15.87cwt	1032kg/20.31cwt
5.10	5.18m/17'0"	6.22m/20'4"	2.06m/6'9"	2.39m/7'10"	926kg/18.23cwt	1200kg/23.5cwt
5.70	5.79m/19'0"	6.83m/22'4"	2.06m/6'9"	2.39m/7'10"	1180kg/23.22cwt	1400kg/27.55cwt

Note: All imperial figures are rounded up to the nearest inch. Every effort is made to ensure the accuracy of these statistics but they may vary depending upon conditions at the time of manufacture.

ABI TARGET	Bed Sizes
3.90	6'3" x 3'8" (D) 6'3" x 1'11" (S) 6'0" x 1'8" (HB)
4.50	6'3" x 3'8" (2D)
5.10	6'3" x 3'8" (D) 6'3" x 5'0" (D) or 6'0" x 2"2½" (2S) and 6'0" x 1'8" (B)
5.70	6'3" x 3'8" (D) 6'3" x 6'1" (D) or 6'3" x 3'2" (2S) and 6'0" x 1'8" (2B)

Note: D—Double Bed, S—Single Bed, HB—Hammock Bunk, B—Bunk

Standard features on all Target caravans: Full insulation, polyplastic sealed tinted double glazed windows, 2 cu. ft. fridge, pinch-pleated curtains, fitted carpets, high quality upholstery, transistorised electric lighting, Formica work surfaces and table coverings, gas bottle locker and fairing for two 15lb. gas bottles, radial ply tyres, Sigma back-up system, hand basin and pumped water in toilet, full awning channel, independent suspension, full frame steel channel chassis, pre-formed plastic rear panel enclosing road lights and fog lights, two 7 pin electrical connectors and sockets, stable door, continual flow ventilation, roof light, door mat. The 5.70 model has a shower, mains/12 volt transformer/charger and larger heater.

- A Dinette/Double Bed.
- B Dinette/Single Bed with Bunk over.
- C Single Bed.
- G Table.
- I Full Cooker.
- J Stainless Steel Sink Unit.
- K Wardrobe.
- M Wall Locker.
- N Shelf.
- O Toilet with Vanity Unit.
- P Roof Light.
- T Heater.
- U Fridge.
- V Shower.

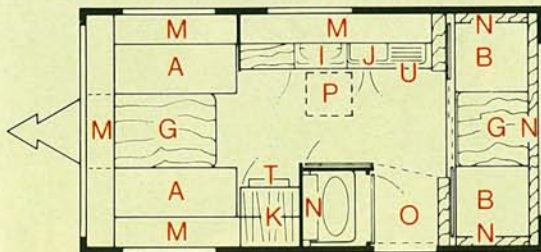

ABI TARGET 3.90. 4 BERTH

Front double dinette (double bed), rear single dinette (single bed with bunk over), centre toilet compartment with wash hand basin and vanity unit, centre kitchen with fridge, oven, two burner/grill cooker and stainless steel sink, ample wardrobe, cupboard and locker storage space, dual manual/electric water pump.

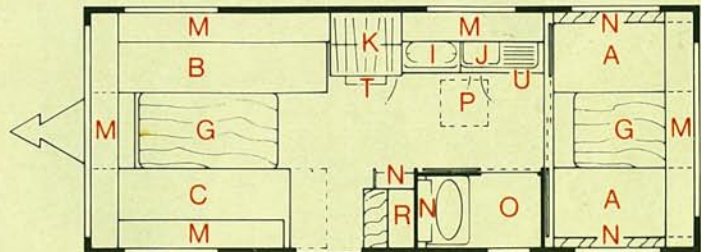

ABI TARGET 5.10. 5 BERTH

Front king-size dinette (two single beds with sprung bunk with safety rail above), rear double dinette (double bed), centre toilet compartment with wash hand basin and vanity unit, centre kitchen with fridge, oven, two burner/grill cooker, stainless steel sink, dual manual/electric water pump, ample wardrobe, cupboard and locker storage space.

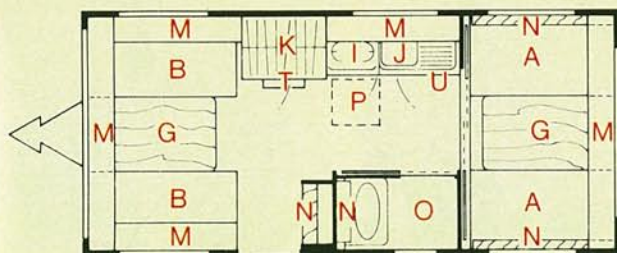

ABI TARGET 4.50. 4 BERTH

Front double dinette (double bed), rear double dinette (double bed), centre toilet compartment with wash hand basin and vanity unit, centre kitchen with fridge, oven, two burner/grill cooker and stainless steel sink, ample cupboard, wardrobe and locker storage space, dual manual/electric water pump.

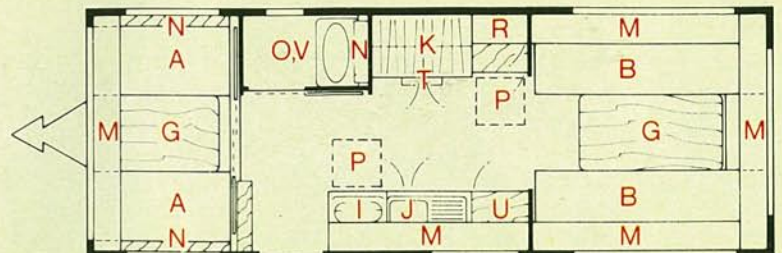

ABI TARGET 5.70. 6 BERTH

Front double dinette (double bed) rear king size dinette (single beds and sprung bunks with safety rails above), centre toilet with wash hand basin, vanity unit and shower, centre kitchen with fridge, oven, two burner grill/cooker, stainless steel sink, dual manual/electric water pump, ample wardrobe, cupboard and cooker space.

THE ABI AWARD RANGE



What we have here is the nearest thing you could get to a country home on wheels. Electric lighting, gas heating, built in fridge and full size oven all come as standard. And new this year is a mains/12 volt electric transformer.

Outside new aluminium waist mouldings, stainless steel grab handles and gold coachlines all give the Awards a crisp new look. Not to mention the inlaid panelled



doors and antique finished handles inside.

All four models (there's a new 14ft two berth version) have the same high standard of appointment you'd be proud to invite the squire back to for a quick chaser after the chase.

Once you see inside you can see what we mean.





The simulated french walnut panel finish to the cupboards is as close to an old world country house as anything you are likely to find in a caravan. There's even a Welsh dresser in the 14/2.

And in case you're wondering where the country kitchen is, it's at the top left opposite. That's the beauty of it, everything slots nicely away behind closed doors. Until you need it. Then you've got enough room for stores and enough workspace to cook for a house full. There's enough room in the oven and fridge as well. And incidentally the fridge works on electricity as well as gas. As does the lighting system in the Award. And the mains/12 volt transformer gives you a wide choice of power supply for all your electrics. But then we did say the Award had everything. If the four berth Awards afford you luxury imagine how indulged two of you could be in the new Award for this year. A 14 foot two berth version. The ideal for any couple who want to take their English country home around the country with them. As you will see, the Welsh dresser in the two berth version is much larger. (And so is the cocktail cabinet.) The double bed is also larger and could come a close second to the "Great Bed of Ware".

And throughout there's a Kosset carpet that's so exclusive Kosset didn't send it into the shops before we got it into the Award tourers.

Other standard features include space for two gas bottles up front, vanity unit and roller blind in the wash room, double glazed sealed tinted windows all round, a full awning channel and awning light outside, reading lights and even a set of cocktail glasses.

Can you call such luxuries standard? The Award range for 1980 consists of the 12/2 and the new 14/2 two berth models and the 14/4 and 15/4 four berth versions.





AWARD





AWARD





ABI AWARD

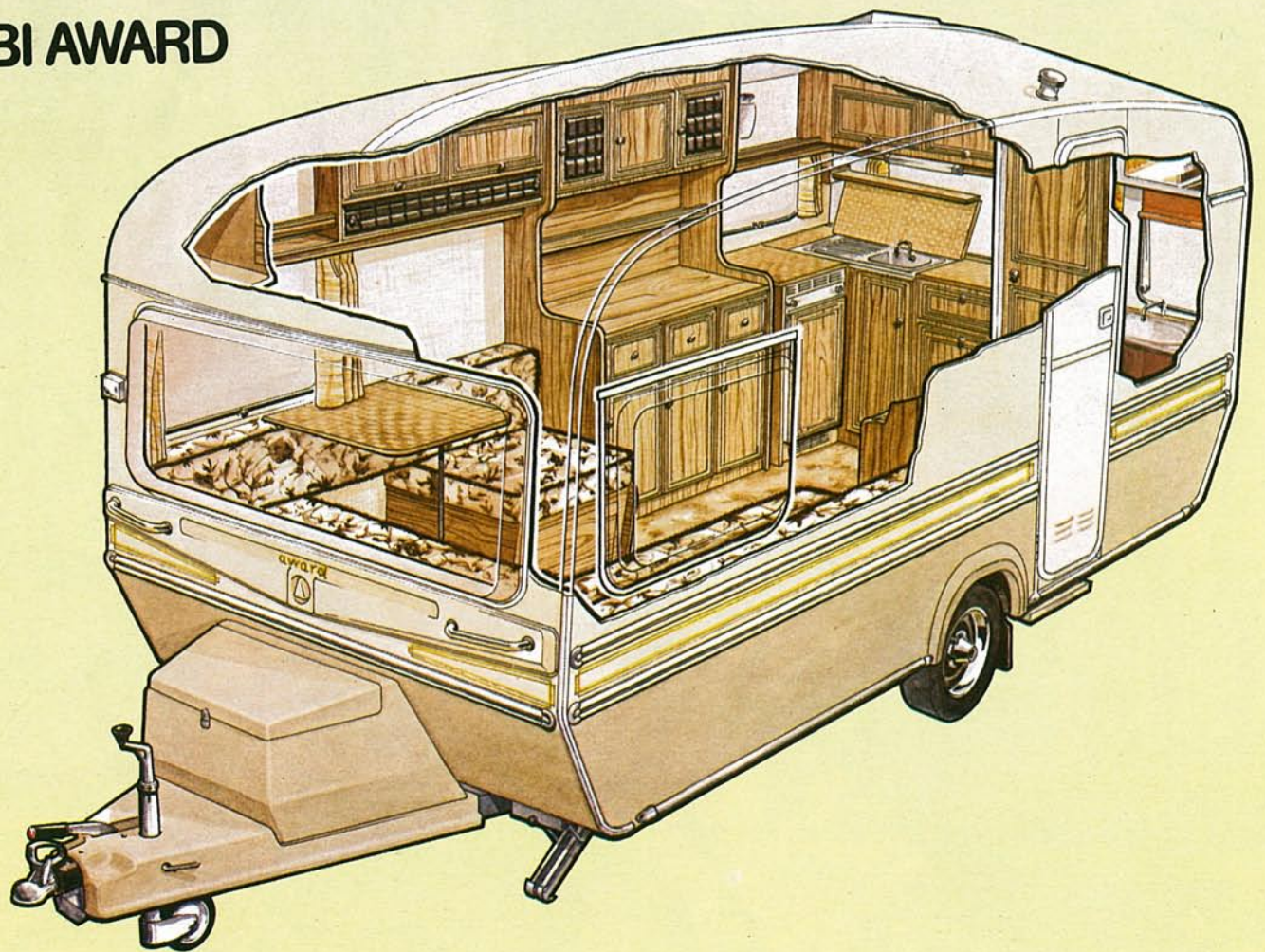

FACT SHEET

ABI AWARD	Body Length	Overall Length	Overall Width	Overall Height	Ex Works Weight	Gross Laden Weight
12/2	3.98m/13'0"	5.00m/16'5"	2.08m/6'10"	2.41m/7'11"	750kg/14.76cwt	902kg/17.75cwt
14/2	4.57m/15'0"	5.59m/18'4"	2.08m/6'10"	2.46m/8'1"	870kg/17.12cwt	1014kg/19.97cwt
14/4	4.57m/15'0"	5.59m/18'4"	2.08m/6'10"	2.46m/8'1"	860kg/16.93cwt	1014kg/19.97cwt
15/4	4.88m/16'0"	5.89m/19'4"	2.08m/6'10"	2.46m/8'1"	880kg/17.33cwt	1084kg/21.33cwt

Note: All imperial figures are rounded up to the nearest inch. Every effort is made to ensure the accuracy of these statistics but they may vary depending upon conditions at the time of manufacture.

ABI AWARD	Bed Sizes
12/2	6'4" x 5'11" (D) or 5'11" x 2'3" (2S)
14/2	6'3" x 2'3" (2S) or 6'4" x 6'3" (D)
14/4	6'4" x 3'11" (D) 5'11" x 2'4" (2S) or 5'11" x 4'0" (D)
15/4	6'4" x 4'1" (D) 5'11" x 3'10" (D) 5'11" x 1'10" (SB) or 5'11" x 2'3" (S) and 5'11" x 1'0" (SB)

Note: D—Double Bed, S—Single Bed, B—Sprung Bunk,

Standard features: Polyplastic sealed double glazed tinted windows, front stone guard panel, gas bottle locker and fairing for two 15lb. bottles, pinch pleated curtains, high quality upholstery, continual flow ventilation, roof light, pre-formed plastic rear panel incorporating rear lights and fog lights, fold-down step, independent suspension, full frame steel channel chassis, Sigma back-up system, two 7 pin electrical connectors, full insulation, full awning channel, two-tone acrylic pre-painted aluminium panelling, awning light, PVC faced plywood interior wall panelling, deep windows, stable door, fluorescent lighting, standby gas light, cooker and oven, 2 cu. ft. fridge, cocktail cabinet, cocktail glasses, set of heat resistant plates, cups and saucers, gas heater, fitted carpets, radial ply tyres, doormat, reading light, mains/12 volt transformer/charger.

- A Dinette/ Double Bed.
- C Single Bed.
- D Settee/ Single Bed with Bunk over.
- E Double Bed with Bunk over.
- F Cupboard.
- G Table.
- H Hotplate and Grill.
- J Stainless Steel Sink Unit.
- K Wardrobe.
- L Chest of Drawers.
- M Wall Locker.
- N Shelf.
- O Toilet with Vanity Unit.
- P Roof Light.
- Q Dividing Curtains.
- R Cocktail Cabinet and Crockery Locker.
- T Heater.
- U Fridge.
- V Oven.

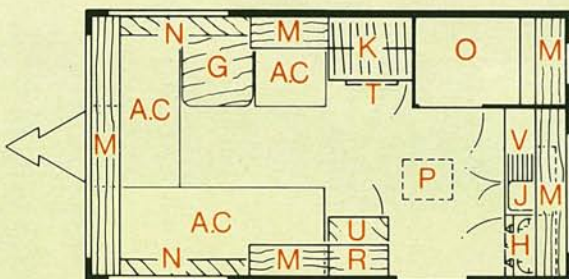

ABI AWARD 12/2. 2 BERTH

Front king-size dinette (large double or two single beds), end kitchen with stainless steel sink and two burner/grill cooker, oven behind concealed doors, end toilet with wash hand basin, centre cocktail cabinet with large fridge under, dual manual/electric water pump, ample cupboard, locker and wardrobe space.

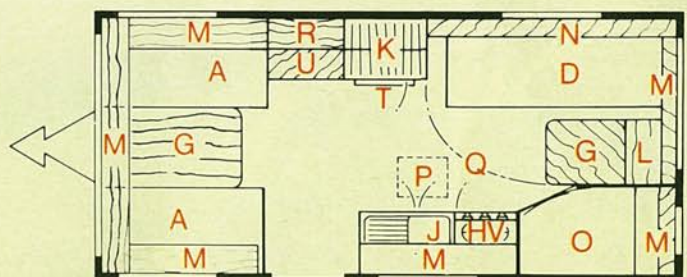

ABI AWARD 14/4. 4 BERTH

Front double dinette (double bed), rear settee (single bed sprung bunk over). Centre kitchen with stainless steel sink, 2 burner grill cooker, oven, large fridge. Ample cupboard, wardrobe and locker storage space. End toilet compartment, with wash hand basin. Dual/manual electric water pump, cocktail cabinet.

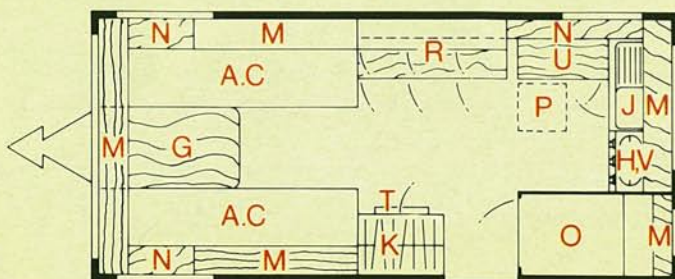

ABI AWARD 14/2. 2 BERTH

Front king-size dinette (large double or two single beds) end kitchen with stainless steel sink and two burner/grill cooker, oven behind concealed doors, end toilet with wash hand basin, centre cocktail cabinet with large fridge underneath, dual manual/electric water pump, ample cupboard, locker and wardrobe space.

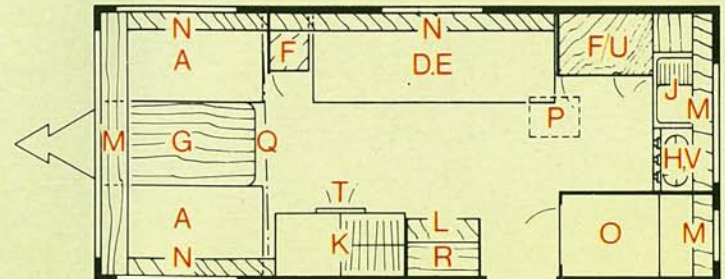

ABI AWARD 15/4. 4 BERTH

Front dinette (double bed), centre settee (single or optional pull out double bed with sprung bunk over), end L-shaped kitchen with two burner/grill cooker, oven and large fridge, dual manual/electric water pump, end toilet compartment with wash hand basin, ample cupboard, wardrobe and locker storage space.

THE ABI CRUSADER RANGE



In an ideal world we would make all our caravans this way. Not a penny spared. Not a compromise made. For us it's a different challenge. Elsewhere, we try to provide the best you can buy for the money. With the Crusader range, it's simply the best you can buy.

The degree of luxury afforded in each of the three Crusader tourers is typified by the



inclusion of such items as a stereo sound system with twin speakers and an autoreverse cassette deck.

Turn the page and we'll take you through them.

Which brings us to the challenge we mentioned. This year how did we manage to improve on what was already superlative. The Crusader range.





Each model in the range has a shower in a toilet compartment which is lit by transistorised electric lighting and equipped with an extractor unit. In each, the kitchen also has an extractor placed discretely over a full sized cooker. And in both areas the hot and cold water is supplied by a new Aqua Marine aquaflow tanked hot and cold water system. So the shower is fully pressurised and temperature controlled.

The Crusaders also have a Primus central heating system and all round double glazing which together with the full inner wall insulation meets Scandinavian standards.

And of course all the electrics in the Crusader are served by one of the best recharging units money can buy. So much for function. As for the form the layouts in the Crusaders could hardly be bettered. The lounge suite converts in seconds into a luxury double bed of gargantuan proportions and the sleeping area is furnished with a wardrobe with a full length mirror and a lockable drawer.

This year a new 15/2 two berth Crusader joins the 13/2 and the 15/4 models. With a large front dinette and end kitchen, the extra space has been used to provide a chest of drawers unit that doubles as a dresser with a fold up middle section and vanity mirror.

In the kitchen, the Crusader is equipped with a full size cooker, 2 cu.ft. fridge and cupboards beyond belief, an air extraction system, stainless steel sink and drainer and tapped hot and cold water.

When it comes to the finish, well what can be said, buttoned deep upholstery, luxury carpet, TV point, stereo, lined curtains — the Crusaders are the ultimate in standard luxury at a sensible price.









ABI CRUSADER

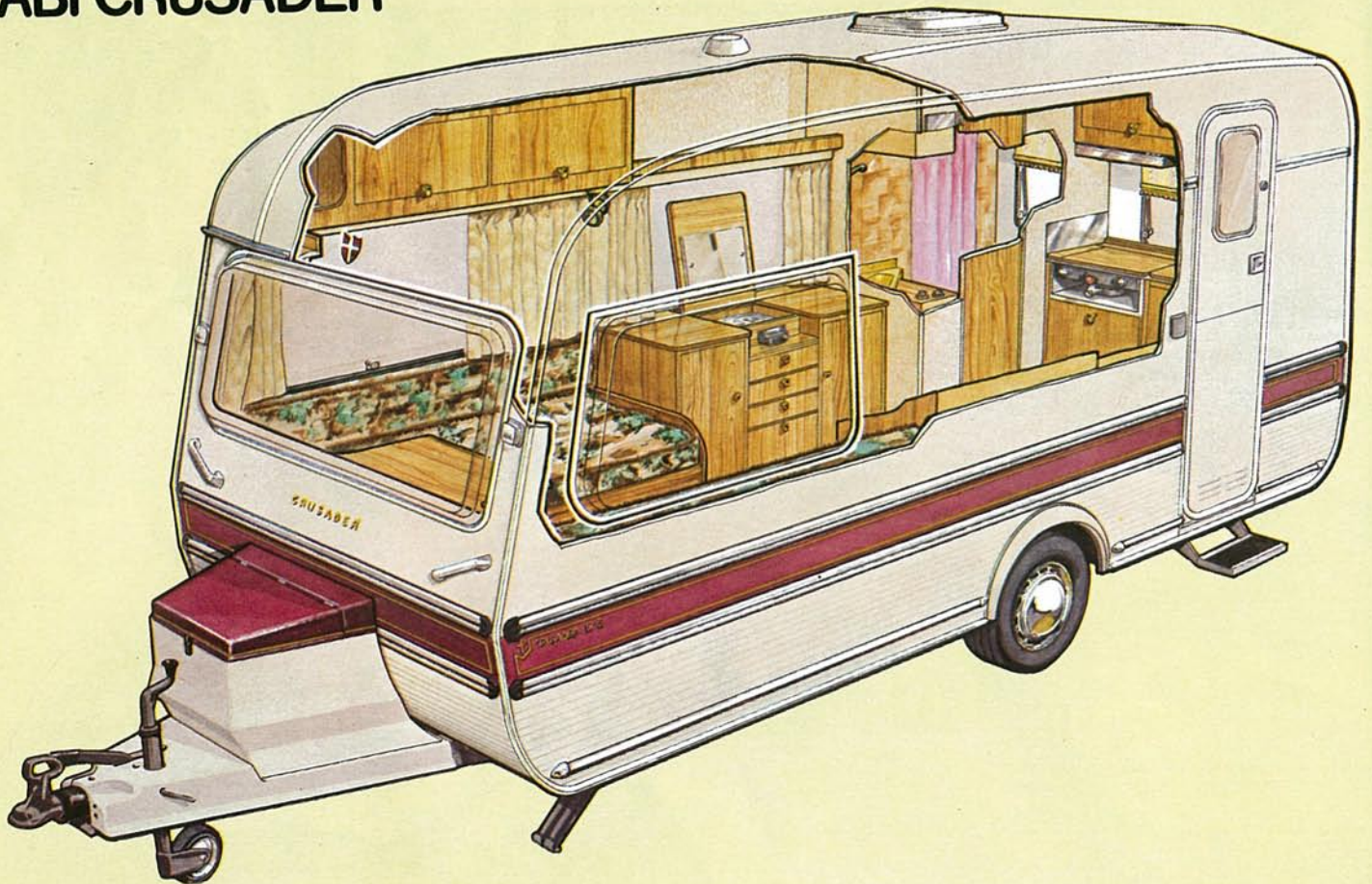

FACT SHEET

ABI CRUSADER	Body Length	Overall Length	Overall Width	Overall Height	Ex Works Weight	Gross Laden Weight
13-2	4.17m/13'8"	5.28m/17'4"	2.08m/6'10"	2.54m/8'4"	940kg/18.5cwt	1080kg/21.26cwt
15-2	4.83m/15'10"	5.92m/19'5"	2.11m/6'11"	2.51m/8'3"	1060kg/20.87cwt	1270kg/25.00cwt
15-4	4.83m/15'10"	5.89m/19'4"	2.11m/6'11"	2.51m/8'3"	1060kg/20.87cwt	1270kg/25.00cwt

Note: All imperial figures are rounded up to the nearest inch. Every effort is made to ensure the accuracy of these statistics but they may vary depending upon conditions at the time of manufacture.

ABI CRUSADER	Bed Sizes
13-2	6'2" x 2'2" (2S) or 6'2" x 4'3" (D)
15-2	6'3" x 2'3" (2S)
15-4	6'4" x 4'1" (D) 5'10" x 2'3" (S) 5'9" x 1'8" (B)

Note: S—Single Bed, D—Double Bed, PB—Pullman Bunk.

Standard features on all ABI Crusader caravans: Polyplastic tinted sealed double glazed windows, gas bottle locker and fairing for one 15lb. or 30lb. bottle, 20 gauge aluminium cladding, satin anodised grab handles, B & B chassis with torsion bar axle, Lockheed reversing brakes, Sigma 2 coupling, double glazed sky light, Electrolux 212 12v/220V gas fridge, Primus central heating system thermostatically controlled with combined hot water heater (which can be isolated from heating system) hot and cold taps to the wash hand basin and sink unit, shower equipment, stereo cassette player with auto reverse and speakers, stainless steel sink and combined hotplate, full cooker, T.V. point and aerial socket, roller blinds in toilet, rear window and door, awning light, polished Formica furniture in American Cherry, cocktail cabinet with glasses, folding step, awning channel both sides, wardrobe with two drawers one of which can be locked, fixed ventilation in toilet roof, pinch pleated lined curtains, loose cushions, full insulation to Swedish standards. The Primus central heating boiler with 3½ gall. indirect cylinder water heater is a combined unit which provides hot water to radiators and faucets in the toilet and sink unit. During warmer weather the boiler can be left on and the radiators turned off to give only hot washing water by simply operating a valve in the front of the caravan, the radiators can be simply turned back on again should the weather change. A 7½ gall. inboard water tank is fitted with an external fitted socket for a submersible pump. A charging unit is fitted and will charge the caravan battery from either the towing vehicle or from 220/240v mains. The cooker hood which is fitted has a duo feature which allows extraction from the cooking area or from the adjacent toilet compartment. Lab-Craft recessed RL9 fluorescent interior lights are fitted which are operated by means of separate wall switches. The front light may be controlled from either end of the caravan from two-way switches. Factory fitted option: Red or green upholstery.

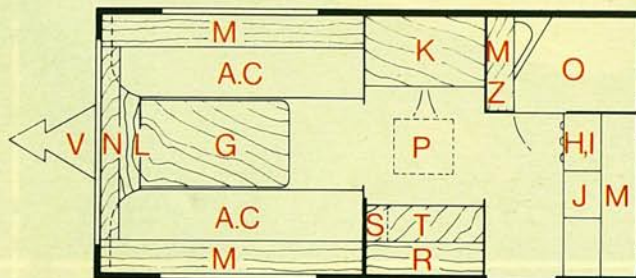

ABI CRUSADER 13-2. 2 BERTH.

Front king-size double dinette with thick upholstery and back rests, (large double or two single beds), end kitchen with stainless steel sink, two burners/grill cooker, oven behind concealed door, end toilet with wash-hand basin and shower unit, centre cocktail cabinet with large Electrolux fridge in matching wood veneer, chest of drawers, centre wardrobe, ample locker and cupboard space, two spotlights above dinette.

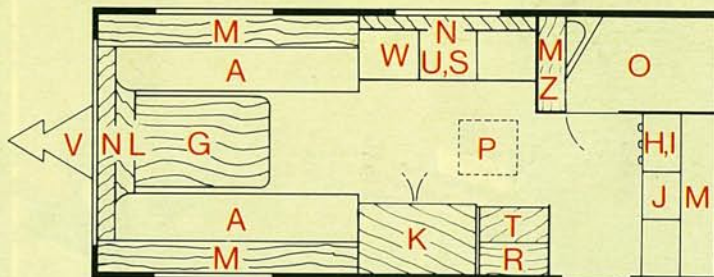

ABI CRUSADER 15-2. 2 BERTH

Front king-sized double dinette with thick upholstery (large double or two single beds) end kitchen with stainless steel sink, two burner/grill cooker, oven behind concealed door, end toilet with wash hand basin and shower unit, centre cocktail cabinet with large Electrolux fridge in matching wood veneer, centre wardrobe, centre sideboard which includes the stereo system and a shelf, ample locker and storage space, two spotlights above dinette.

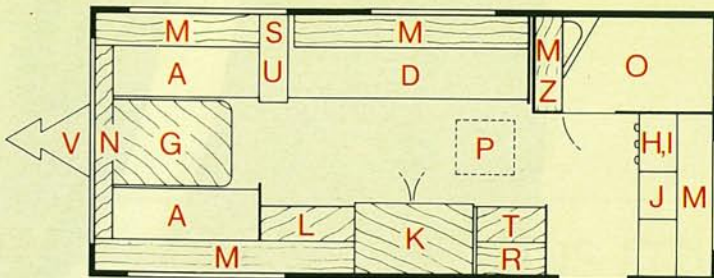

ABI CRUSADER 15-4. 4 BERTH

Front dinette (double bed), centre settee with spring bunk over, kitchen with stainless steel sink, two burner/grill cooker, oven behind concealed door, end toilet with wash-hand basin and shower unit, centre cocktail cabinet with large Electrolux fridge in matching wood veneer, centre wardrobe and chest of drawers, centre armrest with tape holder underneath, locker and storage space, three spotlights above dinette, dividing curtain, lockers under centre settee.

- A Dinette/Double Bed.
- B Single Bed.
- D Settee/Single Bed with Bunk over.
- F Cupboard.
- G Table.
- H Hotplate and Grill.
- I Full Cooker.
- J Stainless Steel Sink Unit.
- K Wardrobe.
- L Chest of Drawers.
- M Wall Locker.
- N Shelf.
- O Toilet with Vanity Unit and Shower.
- P Roof light, Double glazed.
- R Cocktail Cabinet and Crockery Locker.
- S Stereo System.
- T 2cu. ft. Fridge.
- U Cassette Holder.
- V Central Heating Boiler.
- W Sideboard Unit.
- Z Fresh Water Tank.

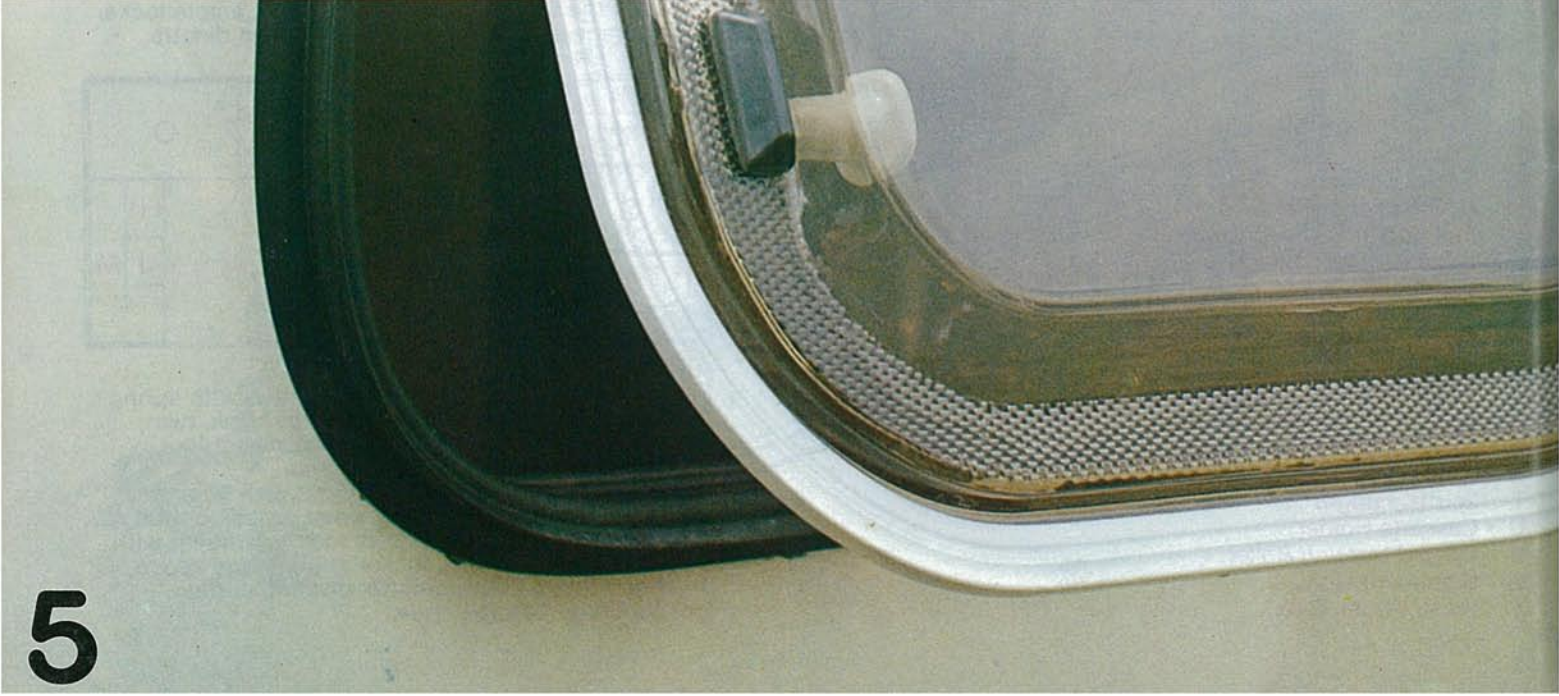

OPTIONAL EXTRAS

1

On the Monzas only, this streamlined fairing on the A-frame, which holds two of the larger (15lb) Continental gas bottles, is an optional extra. It's standard on all the other caravans.

2

If it were only used for keeping a good supply of cooling drinks, this Electrolux fridge would more than earn its keep. But think, too, of crisp salads, fresh butter and milk and — need we say more?

3

Even in the warmest summer there are times — after swimming, or when caught in a sudden shower, or when the evening just turns chilly — when you'd be glad of this heater.

4

When you get a little bored with cooking on the hob or grill, this oven can help add a little taste of variety to your holiday menu. No need to do without the Sunday roast, after all.

5

Another feature which combines good looks and good sense is the special polyplastic windows. Tinted, double-glazed and sealed, they keep out the heat in summer and keep in the warmth in winter.

Many of these items are fitted as standard equipment in most of the ABI range of touring caravans. Please check the individual model range fact sheet to see if any of these extras are standard in the model you are purchasing.

All the photographs, illustrations and descriptive matter in this brochure are intended to give a general idea of the caravan. Changing market and supply situations may prevent us from maintaining the exact specification details in this brochure and we therefore reserve the right to alter specifications and prices as materials and conditions demand. Please check current details with your dealer and inspect the caravan to ensure it is satisfactory before purchase.

Dealers are not agents of ABI Caravans Limited and have absolutely no authority to bind ABI Caravans Limited by any express or implied undertaking or representation.



ABI CARAVANS LTD.

Swinemoor Lane, Beverley,
North Humberside, England HU17 0LJ.
Telephone: 0482 862976
Telex: 52421 and 52622

WEATHER OAK offset Printed in England
All caravans described in this brochure conform to
the British Standard for Touring Caravans: BS 4626.



YOUR ABI DEALER

