

**'CHELTENHAM'**

*THE FINEST RANGE OF*  
**TOURING CARAVANS**

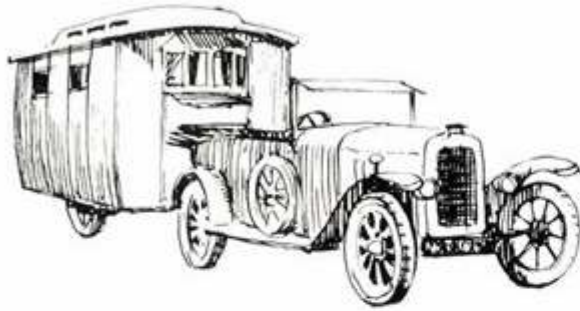

*One of the earliest 'Cheltenham'  
Touring Caravans*

Our first caravan—a converted and lengthened army ambulance—was built in 1921. The serious drawbacks of this type soon became obvious and a change was made to the trailer type. This was a vast improvement but still a bit primitive.

Experience tells—especially some of the longer journeys such as the one to Morocco in 1933—and the design has become more practical and more elegant year by year and TODAY in the world of TOURING wherever you roam, 'CHELTENHAM' is the byword.

At International Rallies Cheltenham's lead the field of British caravans. There were no less than 56 at the International in Hungary and in Israel (1964) half the British contingent were Cheltenham!

New ideas must pass a test over a period of 3–6 weeks and 3,000–5,000 miles before adoption.

---

Our policy is to incorporate improvements after testing, therefore our productions may not conform to illustrations, descriptions, or drawings published here or elsewhere.

## *Here are just a few of the Special Features—*

- Fibreglass roofs, ends and many other parts, give pleasing appearance, great strength and low maintenance costs.
  - Roof, side, and end walls are insulated with expanded polystyrene.
  - A view through the Caravan when towing—using the standard car interior mirror.
  - A really light caravan capable of being towed at high speeds or for long distances without strain.
  - A practical, compact, yet spacious layout.
  - Hydraulic coupling neatly enclosed by a shroud.
  - Gas and electric light.
  - Elegant lines.
  - Fitted carpets are supplied on top of waterproof felt on all models—you choose your colour.
  - A wide range of colour schemes and upholstery materials to choose from.
  - All upholstery is removable for dry cleaning.
  - Anti-splash toilet, hot-plate, regulator, screw type jockey wheel, side lights, rear lights, stop lights and flasher lights are all included.
  - Electric wiring is arranged by means of a seven core cable so that interior as well as full exterior lights are included.
  - All models have at least one bed over 6' 2" in length. The single beds are also extra wide.
  - Details of extras available such as Stable Door, full Cooker, Awning Rail, Refrigerator, electric reversing stop, etc., may be obtained from your Dealer.
- **500 MILES OR 2 MONTH SERVICE**
- To obtain this free service, after 500 miles towing or within two months of purchase, whichever occurs first, all the owner has to do is, by arrangement, to take his caravan to an authorised Cheltenham distributor. The distributor then checks the chassis, adjusting brakes, etc., giving necessary lubrication. Checks and adjusts cupboard catches, gas and electric lights, drawer retainers, etc.
- When collecting the caravan upon completion, the customer checks that the job has been done to his satisfaction and then signs the distributor's chit to enable him to obtain payment from us.
- There is no charge to the customer for this service; it is part of the after-sales service provided for Cheltenham owners, through close co-operation between this company and its distributors.



'SPRINGBOK' - with new exterior styling, at Southfield Manor, Cheltenham, the venue of the Annual 'Cheltenham' Rally.

Anyone who owns a 'Cheltenham' caravan is eligible for membership of The Cheltenham Owner's Club—with its handsome car badge in silver, green and cream; pennant and club tie. Old hands and new comers to caravanning both belong to it and meet in happy holiday mood and environment at the Rally which is held on the weekend following Whit Monday at Southfield, Cheltenham. For further particulars, apply to the Hon. Secretary, Mr. C. H. Gardner, c/o Cheltenham Caravan Co. Ltd., 205 Leckhampton Road, Cheltenham.

Telephone 53695 & 59296

# the luxurious *SPRINGBOK*



now features a lantern roof. This type of roof was always attractive but when built-up in the normal way was heavy and prone to leakage.

Our new type, being moulded in one piece, is lighter and of course, there are no joints to leak! Its reintroduction still further enhances the appearance of this model.

16' 6" (503 cm) long, 6' 9" (206 cm) wide and 6' 5" (195 cm) headroom.

16' 4" long, 6' 9" wide and 6' 4" headroom. Extensive use is made of modern plastics, the moulded bay at either end giving graceful exterior lines, extreme lightness and sturdiness to this model. All of our models have 'wrap round' end sections that eliminate joins at corner which can otherwise be a source of trouble. The rear end bay section makes the kitchen 'open' and pleasant to use. Ventilation louvres for the refrigerator and lavatory compartments are moulded integrally with the section, which adds to the attractive appearance. The toilet compartment is a one-piece self coloured F.R.P. unit with rounded corners. Attractive and hygienic.

The layout of the Springbok is shown on the Key to the plan view, other outstanding features are :—

- Fibreglass roof, front, and back.
- Triangulated chassis with independent suspension and shock absorbers. 6.40 x 15 or 6.70 x 13 — 6-ply tyres.
- The interior is a revelation in Caravan design — walls and furniture of polished oak, ceilings white rippled P.V.C. finish. Spacious compactum, chest of drawers, shelves, roof lockers, large and small table, a smart cocktail cabinet and magazine rack. Fitted carpet.
- The curved kitchen section is very compact with cooker unit and grill. (There is space for a full oven cooker if wanted). Locker for pots and pans, and rubbish bin, large ventilated food cupboard specially designed to take a refrigerator, sink and draining board with water pump, locker for water carrier (supplied) and storage. Roomy crockery cabinet and a cutlery drawer — in fact a very neat layout.

- Toilet — the special caravan type anti-splash model is fitted, also a wash basin with built-in outside waste. Borrowed light panel.
- Beds — two single with special spring base and 4" thick plastic foam mattresses (5" foam mattresses on solid base alternatively), padded sloping backrests, hinged for moving at night give the last word in comfort. The sliding unit double bed has 5" mattresses which are easily and quickly made up and in the daytime provide a charming lounge effect.
- With four opening windows on each side of the lantern roof, first-class adjustable top ventilation is assured. Also good headroom and plenty of light. Top awning rails fitted integrally with gutter all round roof.





SPRINGBOK — views of the interior. The refrigerator shown in the rear view (above) is an optional extra. The chest and hinged table can be seen in the front view (below).

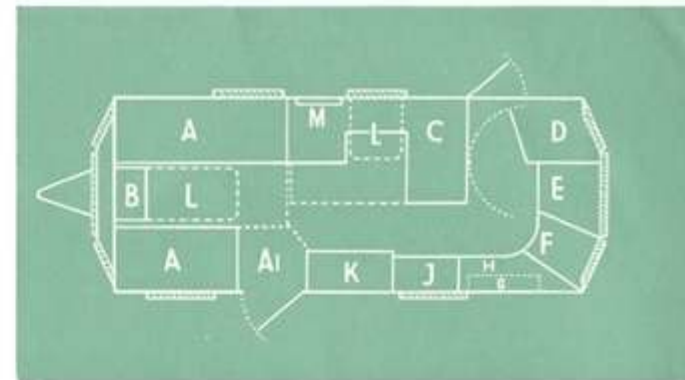

- A Single beds.
- AI Nearside single bed extension.
- B Chest of drawers.
- C Dinette sliding double bed. Alternative settee double bed.
- D Toilet and tip-up wash basin. F.R.P. Fixed vents end and side.
- E Cooker.
- F Ventilated food cupboard or space for refrigerator. Cutlery drawer.
- G China Cabinet.
- H Combined sink and draining board and water pump.
- J Drawers and locker.
- K Compactum.
- L Hinged tables.
- M Paper rack.

Roof lockers above offside single and double beds. Also above sink unit.

Book shelf above nearside single bed.

#### SHIPPING SPECIFICATIONS—

Ex-works weight 17 $\frac{3}{4}$  cwt. (902 kg)

Overall sizes : Length 18' 5" (561 cm)

Width 6' 9" (206 cm)

Height 8' 1" (246 cm)

# the spacious PUKU

is offered as a two or four berth, the former, 15' 0" (457 cm) long, 6' 6" (198 cm) wide and 6' 3" (191 cm) headroom, has all the pleasing and practical features of the Sable, but with added wardrobe accommodation, provision for fitting a refrigerator, fitted gas fire, greater floor area, and two single beds permanently in full length position. The nearside door on the 2-berth is behind the wheel to give this layout. The toilet in this model is now a one-piece self coloured F.R.P. unit—easily kept spotless. Furniture redesigned in accordance with modern concept.



## Puku 4-berth

The exterior is illustrated above; the layout of the front end is similar to the Sable. In the centre, to the rear of the door on the nearside, is a settee type double bed, with kitchen across the rear end. A gas fire point is fitted on the front of the compactum. Suspension (as Springbok) but with lighter springs and 6.40 x 13 tyres.



- Designed for those caravanners who want to be really mobile but also want to be away from home possibly for months on end and wish to take all the necessary equipment in great comfort.
- Morlite roof opening section 4' x 2' affording superb ventilation and light inside the caravan.
- Two doors, end kitchen and toilet. Extensive working surfaces. Plenty of cupboards, two chests of drawers, ventilated food cupboard in addition to a space provided for a refrigerator, roof-lockers and airing cupboard. Special ventilation for refrigerator is also incorporated.
- A compactum plus a gentleman's wardrobe. Fitted gas fire and fitted crockery/cocktail cabinet. Water Pump to sink. Rubbish container.
- Beds—two single, with special spring bases and 4" polyether foam mattress (5" on solid base alternative), extra wide with padded sloping backs.

## SHIPPING SPECIFICATION

### 2-BERTH

Ex-works weight	14½ cwt. (737 kg)
Overall sizes :	Length 16' 10" (513 cm)
	Width 6' 6" (198 cm)
	Height 7' 10" (239 cm)

### 4-BERTH

Ex-works weight	14½ cwt. (724 kg)
Overall sizes :	Length 16' 10" (513 cm)
	Width 6' 6" (198 cm)
	Height 7' 10" (239 cm)

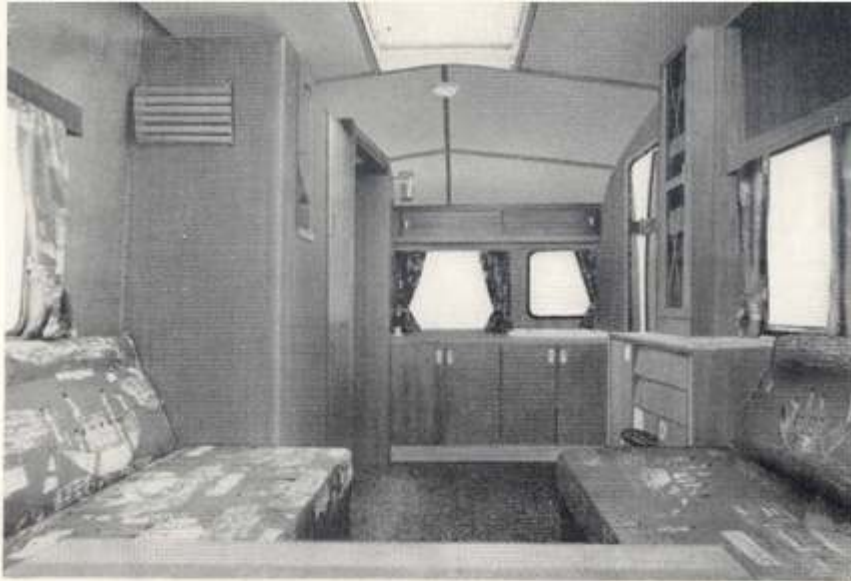

PUKU — View of interior, 2 berth.



- A Single beds.
  - B Cupboard and drawers and ventilated food cupboard. Cocktail/crockery cabinet above.
  - C Built-in gas fire.
  - D Kitchen unit with grillier.
  - E Working surface.
  - F Surface combined sink and drainer.
  - G Toilet F.R.P., fixed vents end and side.
  - H Compactum wardrobe.
  - I Chest of drawers, hinged table on face.
  - J Gentleman's wardrobe with cupboard underneath, ventilated to receive refrigerator if required.
- } Kitchen cupboards under



PUKU — view of interior, 4-berth.

This photograph illustrates a refrigerator which is an optional extra.

PUKU 2-berth ↗  
4-berth ↘

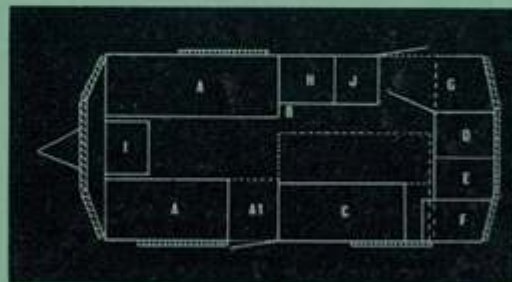

- A Single bed.
  - A1 Floor space in daytime. Bed end moves to form single bed A, A1.
  - B Point for gas fire.
  - C Settee by day extending sideways and longways to form double bed.
  - D Cooker
  - E Working surface
  - F Combined sink and draining board
  - G Toilet F.R.P., fixed vents end and side.
  - H Compactum wardrobe
  - I Chest of drawers with hinged table on face.
  - J Space for refrigerator with fitted crockery cupboard above and ventilated locker below.
- } Kitchen cupboards under

## *the elegant NYALA*



*The elegant Nyala is a model introduced by special request.*

*Similar in size and appearance to the Puku 4, it has an entirely different layout, giving more working surface and more cupboard accommodation.*

*In the front you have a dinette bed, 6' 3" x 4' 2" consisting of 5" polyurethane mattresses on perforated bases.*

*The van can be divided either by a fitted curtain across the centre, or the track can be put round the single beds so that when the children*

*are asleep all facilities of the van are just as available at night as in the day-time.*

*Bay windows both ends as on all models, except Fawn.*

*A water pump is fitted on side of washbasin to draw water from a portable container situated inside or outside as desired. This is a feature of all our models. Fitted handy to the wash-bowl is a rubbish disposal unit.*

*Standard model includes gas and electric lights; gas griller, de luxe Elsan etc., but not the refrigerator.*



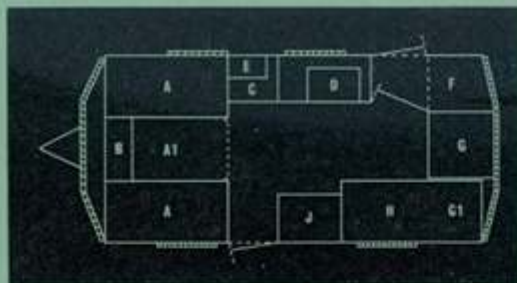

- A Double bed dinette.
- AI Table—also forming double bed A.A.AI.
- B Boot locker.
- C Chest of drawers
- D Sink and draining board—C and D form sideboard unit with lockers, drawers, water storage, room for refrigerator.
- E Wall cupboard—Roof locker extending from E to F above C and D.
- F Toilet F.R.P., fixed vents end and side.

- G Cooker Hotplate—room for B600.
- GI Cooker top—working top extension. Roof locker above G, GI.
- H Single bed. Bunk bed above, permanently hinged. Curtain on rail around H.
- J Wardrobe.

**SHIPPING SPECIFICATION—**

Ex-works weight 14] cwt. (724 kg)  
 Overall sizes : Length 16' 10" (513 cm)  
 Width 6' 6" (198 cm)  
 Height 7' 10" (239 cm)



Interior of Nyala looking to rear of van.



Interior of Nyala looking to front of van

# the world-famous SABLE



Sable with glazed stable door (optional extra)



13' 4" (406 cm) long, 6' 6" (198 cm) wide and 6' 3" (191 cm) headroom. Supreme comfort for two, elegant appearance with bay window at rear as well as front, plenty of space and maximum mobility: the Sable is firmly established as the answer to all these requirements.

The layout is shown on the floor plan and key, demonstrating clearly

- A wealth of working surfaces and storage cupboards. Kitchen end has been designed to take advantage of extra space provided by bay window. Provision is now made for fitting a refrigerator. Two chests of drawers, ventilated cupboard for food, three other lockers for stowage. Detachable rubbish bin. Compartment behind will hold either one water carrier and one cylinder, or two carriers or two cylinders. The flexible lead from the water pump is led into this compartment ready to go into the water carriers which stow in here. Airing cupboard above the cooker. Cutlery and cosmetics drawers. Fitted crockery and cocktail cabinet. Point for gas fire.
- A spacious open layout with plenty of floor space: enough even for an occasional bed on the floor if wanted.
- Two doors.
- Two luxury sized single beds, both 2' 2" wide, and 6' 3" and 5' 11" in length respectively. Both using 4" mattresses on nylon elastic straps (5" on solid base alternative) with padded sloping back rests. The near-side single bed is long enough to put your feet up for an afternoon nap without extension. When extended for full length you still have the off-side door available for use.
- Morlite roof opening section 4' x 2'.
- Choice of exterior and interior colours and finishes, upholstery, carpet, etc.
- Suspension — as Springbok but with lighter springs and 5.90 x 13 tyres.





SABLE—views of the interior.

The refrigerator and stable door shown in the rear view (above) are optional extras.

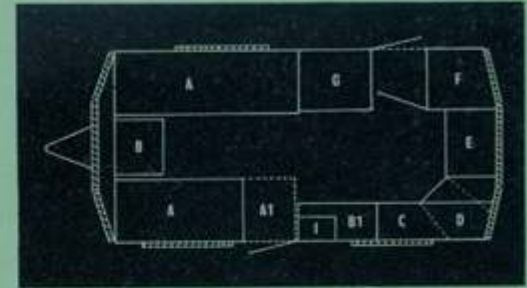

- A Single beds.
  - A1 Floor space in day time. Bed end moves to form single bed A, A1.
  - B, B1 Chests of drawers. (Hinged table on B).
  - C Combined sink and drainer.
  - D Food cupboard or space for refrigerator.
  - E Cooker unit.
  - F Toilet. F.R.P., fixed vents end and side.
  - G Compactum.
  - I Cocktail and china cabinet.
- B1, C, D, E, are all working surfaces.

#### SHIPPING SPECIFICATIONS—

Ex-works weight	12½ cwt. (648 kg)
Overall sizes :	Length 15' 3" (465 cm)
	Width 6' 6" (198 cm)
	Height 7' 9" (236 cm)



## the fleet FAWN

*This, as the name implies, is the smallest in our range. Introduced four years ago, this caravan is now a proved winner. Generally speaking, vans of this length are too small to be comfortable. Five could feed in this model quite easily, and a 6 foot person need not feel cramped by day or night — one bed is 6' 3".*



← Rear view of the Fawn showing the spacious picture window.

- Two berth, 11' 2" (340 cm) long, 6' 3" (191 cm) wide, and 6' 3" (191 cm) headroom. The body styling has an F.R.P. roof coming down to top of window level, and with the rainwater gutter moulded into the exterior profile. The F.R.P. front and rear sections have deep 'wrap round' sides, and a 4' 6" rear window, top hinged, gives panoramic views.
- Apart from the beds, main features are an end kitchen, compactum type wardrobe, cooking and washing facilities, and an adequate toilet compartment complete with Elsan.
- Mattresses on this model are 5" polyurethane foam on solid bases — covers to choice.
- The door is on the offside. This arrangement will be appreciated abroad — where many of these vans will undoubtedly go — and is by no means unpopular at home.

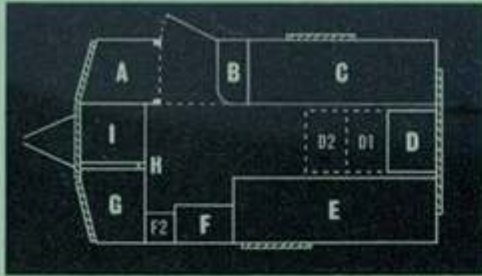

- A Toilet compartment fitted with Elsan or similar.
- B Stores cupboard with lined working surface above.
- C Single bed 5' 11" with hinged back rest. Large storage space below—magazine rack and roof locker above.
- D Chest fitted 3 drawers and a locker. Hinged top extends to position D1 or D2 as required.
- E Single bed 6' 3" with locker under and locker and china cabinet above.
- F Compactum type wardrobe.
- F2 Hinged working top and space for refrigerator.

- G Combined sink and drainer with cupboard under.
- H Water pump.
- I Hotplate with locker under. Complete inside and outside electric lighting seven core cable supplied. Gas lighting also included.

**SHIPPING SPECIFICATIONS—**

Ex-works weight 11 cwt. (559 kg)  
 Overall sizes : Length 13' 2" (401 cm)  
 Width 6' 3" (191 cm)  
 Height 7' 8" (234 cm)



Interior of Fawn looking at kitchen and toilet compartment



Interior of Fawn looking to the rear of van  
 Chest of Drawers now made in new style

# the lightweight WATERBUCK



Also with bay window at rear end. 13' 4" (406 cm) long, 6' 6" (198 cm) wide, and 6' 3" (191 cm) headroom. Designed for the small car owner who wants comfort on site and on tow with maximum mobility. It is available as either a three or four berth model, the latter having a stretcher type bunk in addition to the single bed.

- Fibreglass roof, front and back.
- Morlite 4' x 2'.
- Compact end kitchen which can be used even when single bed and bunk are in use. Water pump fitted at sink. Self-contained lavatory compartment.
- Good size ventilated larder with extra working surface covered in Formica or similar material, and with fitted crockery stowage above.
- The wardrobe door and extension door meet the wall locker door to form a division when required.
- Choice of soft trimmings, interior finishes and exterior colours. Fitted carpet.

- Dinette double bed at the front end, with the table forming centre section at night, with 5" mattress. Single bed, extending simply at night, using 4" mattresses on sprung base. In the 4-berth a detachable and easily erected bunk is positioned above the single bed when required. The bunk is one unit with canvas top, and is permanently hinged to side of van.
- Compactum with shelves and generous hanging space. Chest of drawers, wall cupboard and roof-lockers and shoe-locker at front end for extra storage.
- Suspension — independent suspension, and an hydraulic hitch, used so successfully on the remainder of the range, are fitted on the Waterbuck.

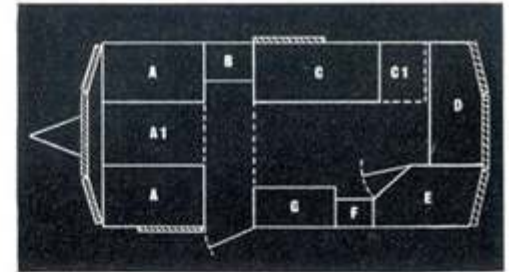

- A Double bed dinette seats.
- A, A1 Double bed using table A1.
- B Chest of drawers with wall cupboard above.
- C Single bed.
- C1 Floor space in daytime. Bed end forms single bed C C1 at night. Bunk bed above C, C1.
- D Kitchen unit with griller, combined sink and draining board with pump, lockers beneath and above.
- E Toilet. Fixed vents end and side.
- F Food cupboard or space for refrigerator and crockery cabinet above.
- G Compactum. Doors used for dividing caravan into two rooms.

## SHIPPING SPECIFICATIONS—

Ex-works weight 12½ cwt. (635 Kg)  
 Overall sizes : Length 15' 3" (465 cm)  
 Width 6' 6" (198 cm)  
 Height 7' 10" (239 cm)



## Practical features of a 'CHELTENHAM'

**DOOR RETAINERS** : these are positive and will hold the door in any wind.

**RECESSED DOOR HANDLES** : no risk of them being 'caught'.

**BUILT IN LIGHTS** : to avoid cutting the panel, recesses are moulded into it so that if rain should get past the lamp glass, it cannot get into the van.

**ROBUST HANDLES OR GRAB RAILS**.

**DRAWERS THAT ARE SELF LOCKING** : you will not find them on the floor when you stop for the night.

**DUST HOLE** : standard on Springbok and optional on other models. It can also assist ventilation.

**BOTTLE CLIPS** : very useful.

**NEW WAISTLINE** : this is smarter looking and will remain so much longer than aluminium moulding.

**FOLDING HOOKS** : on certain models; these are shapely things that certainly do not spoil the interior — they are a godsend at night!

**DRAUGHT EXCLUDER TO ALL EXTERIOR DOORS** : very necessary in this climate. →

**RUBBISH BINS** : as fitted to certain models, are detachable for easy emptying and have rounded corners for easy washing.

**FITTED CROCKERY CUPBOARDS** have been redesigned to accommodate "Gaydon" melamine crockery.

**FRONT CHEST AND TABLE** : the chest is designed in accordance with modern trend. Note the three positions for table, (a) folded completely out of the way when not required, (b) half open when required for writing a letter etc., and (c) fully open to give ample space for meals etc.

**INTERIOR ELECTRIC LIGHTS** : heavier wiring is used to ensure a really good light. Every model also has gas lighting. ↘

**GAS STOWAGE INSIDE** : no unsightly cylinders stuck around.

**WORKING SURFACES** : all in a pleasing shade and style of heat-resistant melamine.

**LARDERS** : are ventilated underneath and at the back.

**ROOFLIGHTS** : there is considerable overlap so these can remain open except under very adverse conditions. A lifting mechanism is incorporated.

**LOW WINDOWS** : for view through and good visibility inside vans.

**SPRUNG BASE FOR SINGLE BEDS** : nylon elastic straps have just that 'give' which comfort demands.

**EXTENDED BED END** : special design ensures easier handling.

**PLATE RACKS** : are fitted as standard on all models.

**SINGLE BEDS** : the back rests are padded and hinged in such a way that they are sloping to support your back in day time and fall back out of the way at night. The front fascia slope back 3 inches to allow easier ingress. This also improves the appearance of the van.

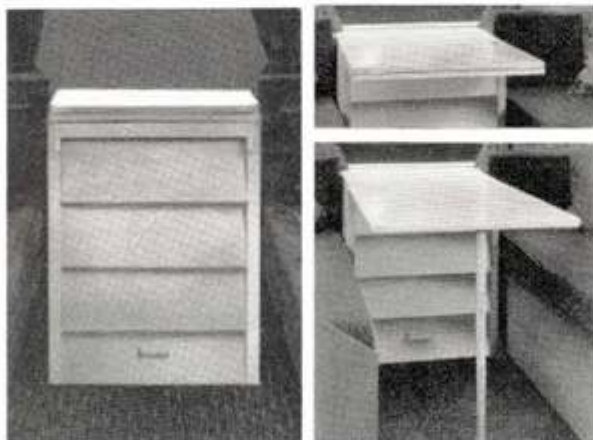

## COLOUR SCHEMES:

### Exterior Treatment

All models are finished in Old English White as standard. As an alternative, they can be finished either Vellum, Pearl Grey, Lichen Green or Ice Blue. Further, the trim (gutters, window hoods, valances, tow bar shroud and wheels) may be in a contrasting colour; this second colour can be any of those already mentioned or Carnation Red, Lethbridge Green, Thames Blue, Powder Grey, Sky Blue, and Fiesta Yellow.

**Interior decor** : standard models are finished in polished oak furniture and walls. As alternatives, they are available with walls and furniture in 'limed' oak.

There is a wide choice of upholstery patterns offered in our range, and good quality patterned carpet is available in a choice of colours. All above alternatives are at no extra charge.

In addition to the standard range of upholstery, there are some "special grade" materials offered at extra charge.

## CONSTRUCTION DETAILS

All floors are tongued and grooved, except the Fawn, which uses waterproof plywood. Insulation felt on all floors underneath carpet.

Sides on all models are curved. Besides giving a graceful shape, they also make the shell extremely strong and reduce wind resistance.

Roofs on all models are made of fibreglass reinforced polyester resin, and are moulded in one piece with gutters incorporated. This ensures that there are no roof or gutter joints which might give rise to leakage. All models have similarly constructed F.R.P. bay front units. Also, the rear end units are made in this manner.

Fibreglass reinforced polyester resin lends itself to attractive shapes; it is extremely strong and light, has low maintenance costs, is easily repaired, and is a thermal and acoustic insulator.

Side panels are clad in 18 swg aluminium — a heavier gauge than usual, to give increased strength, durability and rigidity. Expanded polystyrene insulates all shell cavities.

## THE "CHELTENHAM" TRIANGULATED CHASSIS

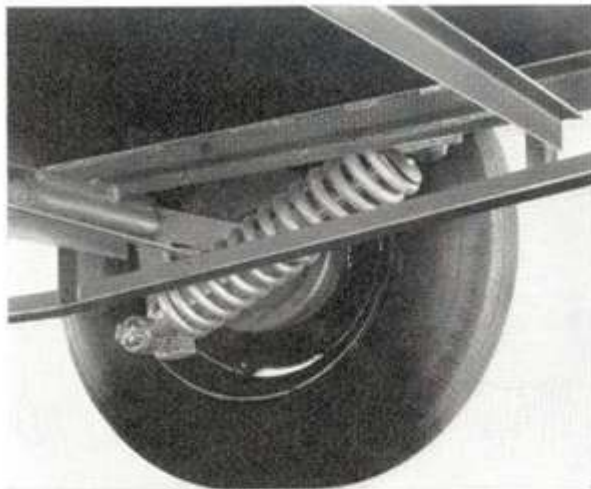

The independent suspension has been used most successfully for six years and is fitted on all models. Shock absorber incorporated within the spring.

The trailing arm is carried in nylon bearings which require no lubrication. Neither do the rubber bushes which carry the shock absorber. Large brakes (9") are used on the "Springbok"; the "Sable", "Puku", "Nyala" and "Waterbuck" having 8" brakes with wide shoes; the "Fawn" has 7" brakes. They have triangulated chassis members for rigidity. All brakes are of the rod-operated centre pull type with compensating mechanism.

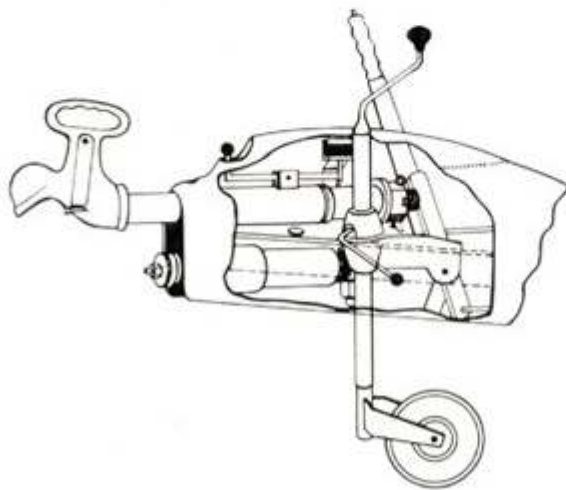

The hydraulic shock absorber on the head, which is standard on all models, ensures that the brakes are applied very smoothly and yet allows them to act powerfully when required. It also takes care of any tendency to 'hunt'. A further refinement is the separate car type hand-brake which can also be applied by the car in the event of a break away. Electric reversing stop is now available.

The unladen weight is shown on the nearside of each van as required by law. This should not be confused with the ex-works weight, i.e., weight of complete van and equipment as it leaves us, which is clearly shown for each model in this brochure.

All chassis are designed for use behind private cars. If a commercial type vehicle is to be used we should be notified.

## Guarantee

A written guarantee for one year will be sent to each purchaser upon receipt of the form — sent out with each van — duly completed.

TERMS OF BUSINESS — All Prices include Equipment.

All prices are ex-works. Orders should be accompanied by deposit of ten per cent, the balance being payable on delivery except when Hire Purchase arrangements have been made. Orders will be executed to time promised unless through circumstances beyond our control, but no responsibility can be accepted for late delivery.

Orders are accepted on the understanding that price charged will be that ruling at time of delivery. The Company's policy, however, is to avoid any increase during the season if at all possible.

None of our products may be exhibited at any show without our written permission.

Collection from the works may be made from Mondays to Fridays, and must be executed within 48 hours from the final completion date that we gave to our distributors. We strongly recommend that customers take delivery from the distributor or agent supplying the caravan: all of our distributors are equipped to service and check caravans, and the check that they give to caravans after road testing during collection is an important feature in the service that they offer.

Our distributors also have facilities for fixing tow-bars and ball headed pins, checking that cars are correctly wired and that the whole electrical installation is functioning correctly. They also have stocks of accessories to meet the customer's last minute needs.

**Over forty years'  
experience of practical  
caravanning in the  
design and construction**